

Baby Walkers USE and Installation Diagram

Item No: #507

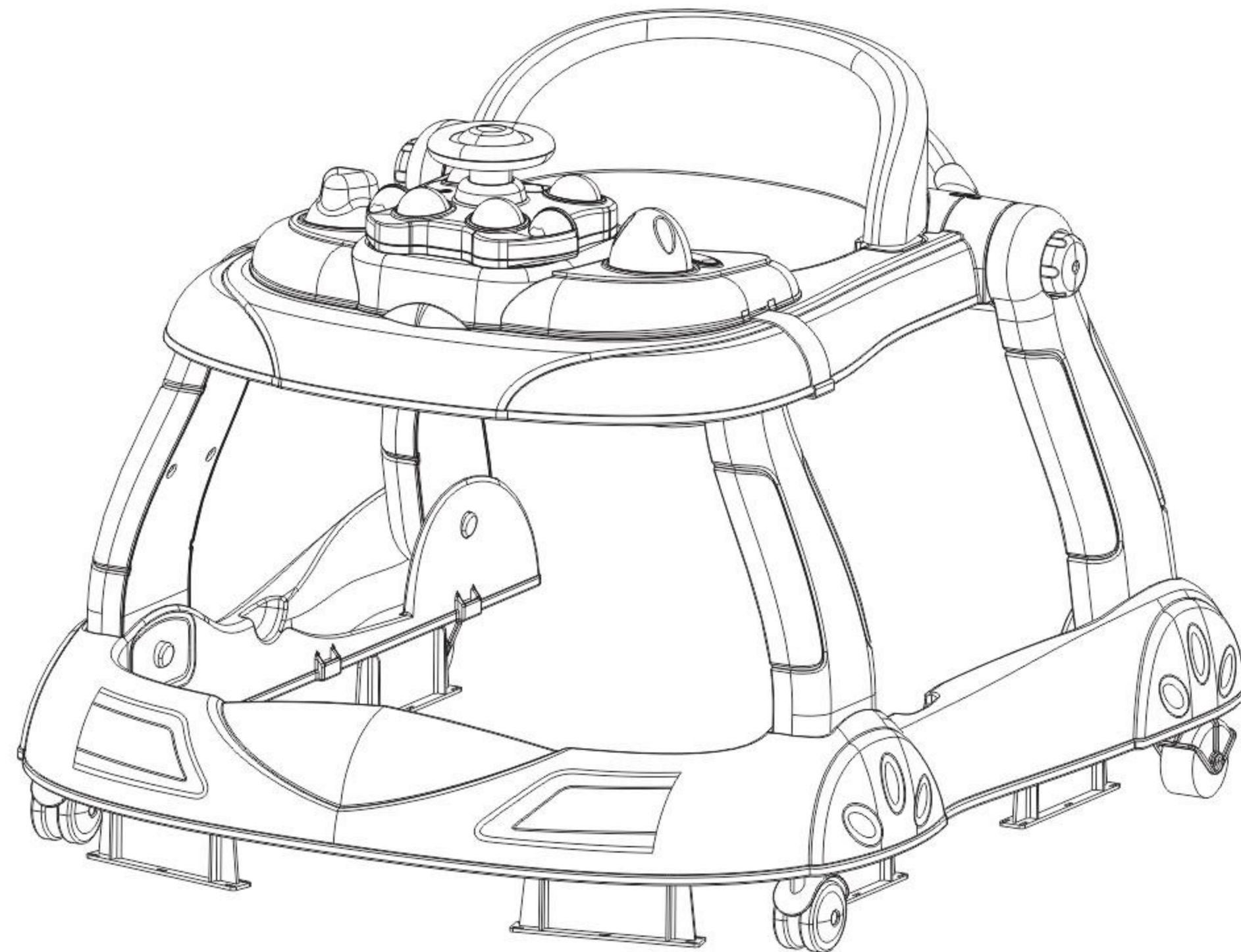

1. Activity Walker

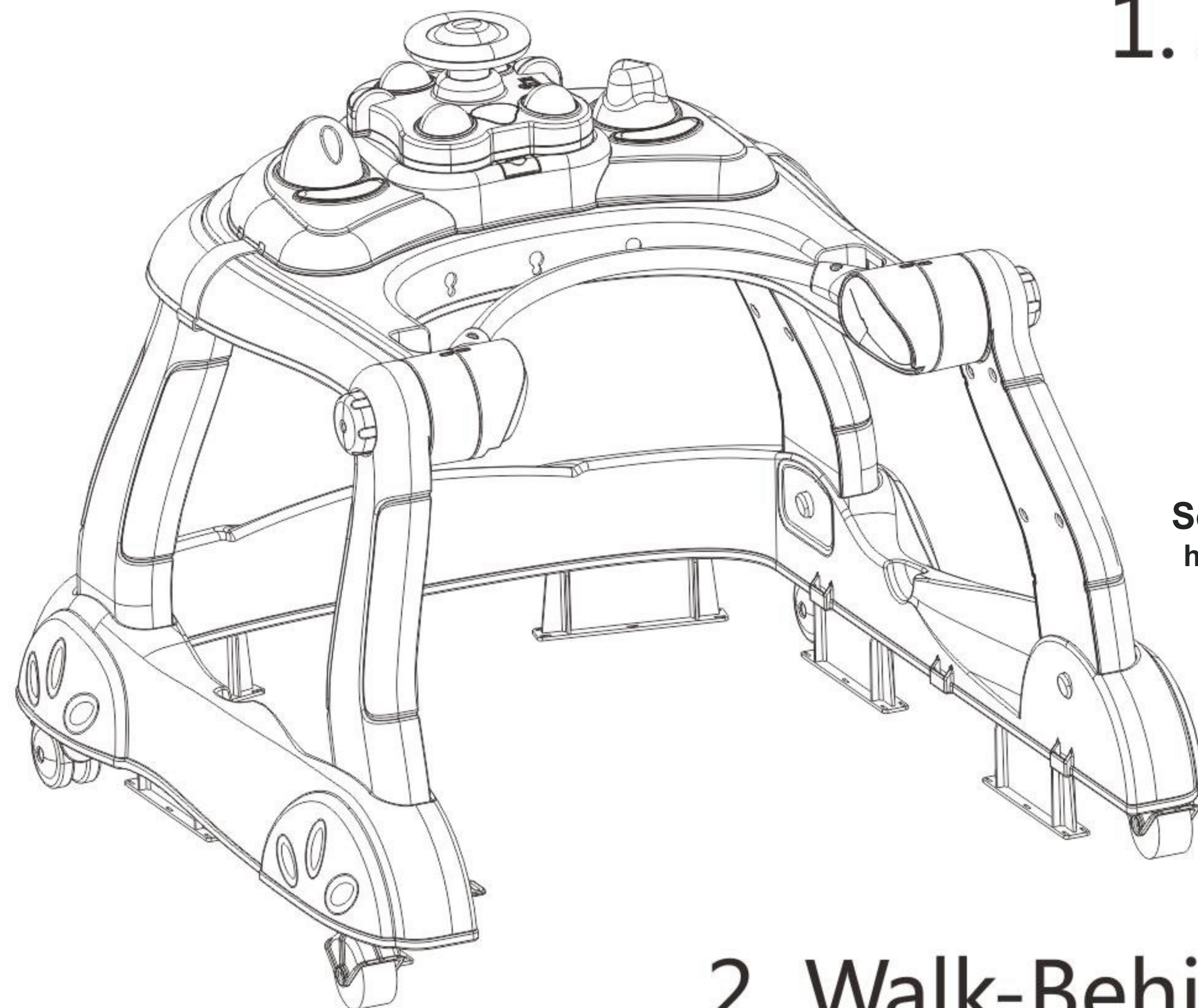

2. Walk-Behind Walker



Scan the QR code to register your product
<https://dreamonme.com/customer-care/registration/>

Read the instructions carefully before use and keep them for further reference. The child may be hurt if you do not follow these instructions.

Product Standard: ASTM F977-12

USER INSTRUCTIONS

⚠ WARNING:

1. Prevent collisions with glass in doors, windows and furniture;
2. Do not use the baby walking frame if any components are broken or missing;
3. This baby walking frame should be used only for short periods of time (e.g. 20min) ;
4. This baby walking frame is intended to be used by children who can sit unaided, approximately from 6 months. It is not intended for children weighing more than 12KG; Do not use until baby can sit up by itself.
5. Do not use replacement parts other than those approved by the manufacturer or distributor;
6. Ensure that all locking devices are engaged before use;
7. Do not impose any extra weight as this may affect the walker's stability;
8. Make sure the child's feet touches the ground when riding. Make sure the child is not in when moving the walker;
9. Clean (friction components) regularly to maintain stopping performance.

⚠️WARNING:

ALWAYS FOLLOW THE MANUFACTURER' S INSTRUCTIONS. NEVER LEAVE YOUR CHILD UNATTENDED. ALWAYS KEEP CHILD IN VIEW WHILE IN WALKER.

USE ONLY ON FLAT SURFACES FREE OF OBJECTS THAT COULD CAUSE THE WALKER TO TIP OVER TO AVOID BURNS, KEEP THE CHILD AWAY FROM HOT LIQUID, RANGERS, RADIATORS SPACE HEATERS AND FIREPLACES ETC. . .

⚠️WARNING-STAIR HAZARD:

TO AVOID SERIOUS INJURY OR DEATH, BLOCK STAIRS/STEPS SECURELY BEFORE USING WALKERS.

CARE AND MAINTENANCE

1. Ensure that all parts are working well before use. Always check parts regularly for wheels, locking devices, seat pad and so on every 15 days.
2. In some climates the covers and trims may be affected by mould and mildew. To help prevent this occurring, do not fold or store the product if it is damp or wet.
3. Wipe plastic parts with a damp cloth using mild soap.
4. To clean the seat pad, footpad, canopy, use only mild household soap and warm water with a sponge or cloth. DO NOT MACHINE WASH.

1. TO ASSEMBLE ACTIVITY WALKER

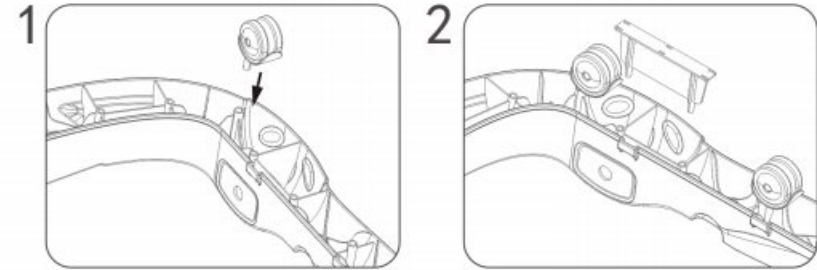

1. Using the wheels: Fit the wheels in the appropriate housings. Ensure that the wheels are firmly pushed all the way into the housing on the base of the walker. (If need use friction pads, only attach two rear wheels in front, two rotate wheels at back.)
2. Using the Non-skid friction pads: Fit the pads into the appropriate housings. Ensure that the joints are firmly and correctly fitted to the end.

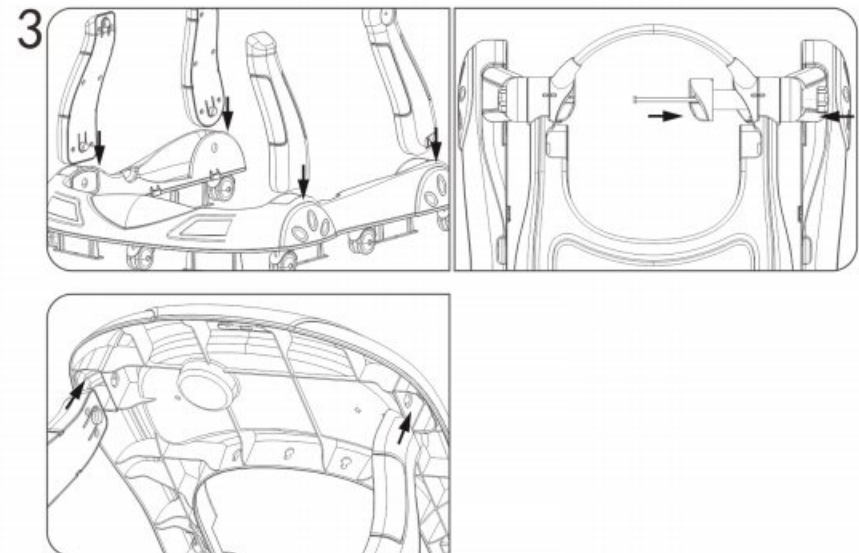

3. Using the legs: Insert the legs into the slots in the base. Press down until the leg buttons locks into the base. Fit top tray and back legs together with 6*100 axles, and then screw nuts on. Insert front legs into the top tray and press down until they lock in place.

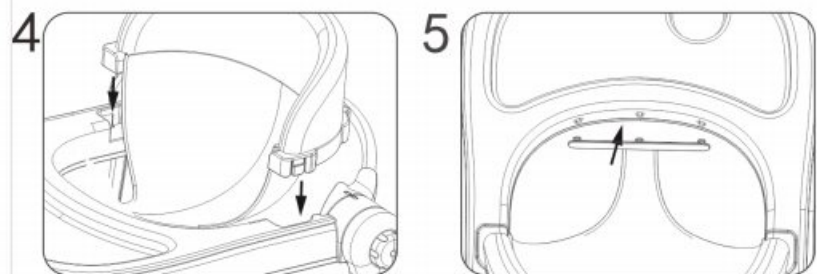

4. Attach Seat Pad: Place seat pad into slots located on top tray until it clicks into place.

5. Attach Seat Pad: Insert the plastic pins on the front of the seat into the holes, then click the pins into position by pushing them downwards.

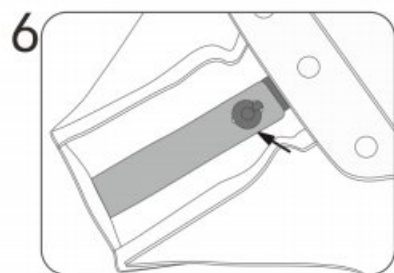

6. Using the Height Adjustment : Adjust to desired position, using the adjustable device located on the seat pad.

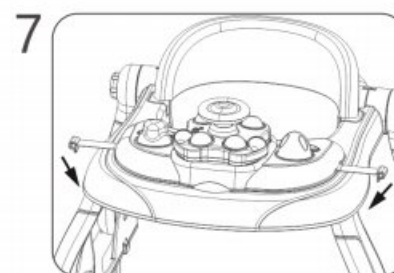

7. Using the music tray: Place the music tray in front of the top tray and lock the hooks on top tray.

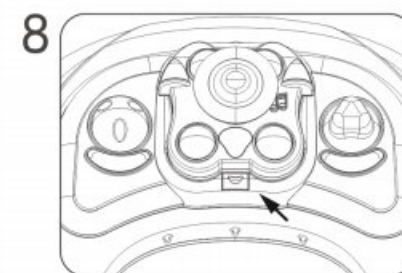

8. Removing the Toy: Press in the release buttons to release the toy from the music tray

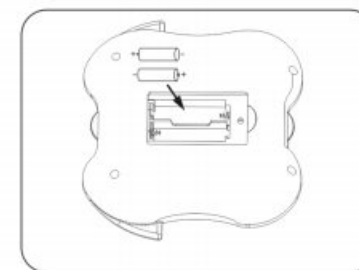
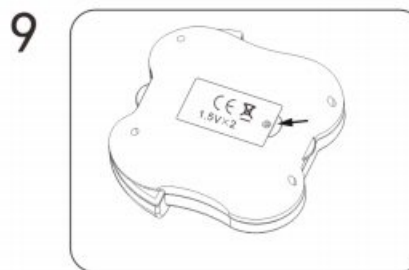

9. Installing batteries

①. Gently pull off tank toy from toy tray.

②. Remove cover from under the tank toy.

③. Install 2 × "AA" (1.5V) alkaline batteries (not included) into battery compartment. Ensure that the batteries are facing the appropriate polarity.

④. Replace cover and screw it back to the tank toy.

⚠️WARNING:

Do not mix old and new batteries.

Do not mix alkaline, standard(carbon-zinc) or rechargeable (nickle-cadmium) batteries.

Do not charge non-rechargeable batteries.

Adult supervision is required when charging rechargeable batteries.

Always remove flat or exhausted batteries from the toy.

Do not short circuit the supply terminals.

2. TO CONVERT TO WALK-BEHIND WALKER

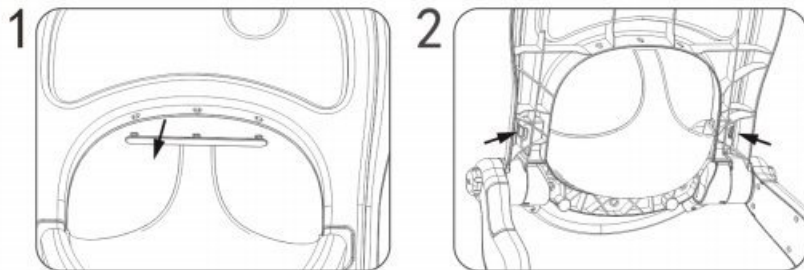

1. Remove the plastic pins: Pulling them up to bigger holes, and then remove out.

2. Remove the seat pad: Press in the release buttons and pull out and up to release the seat pad shown in figure 2.

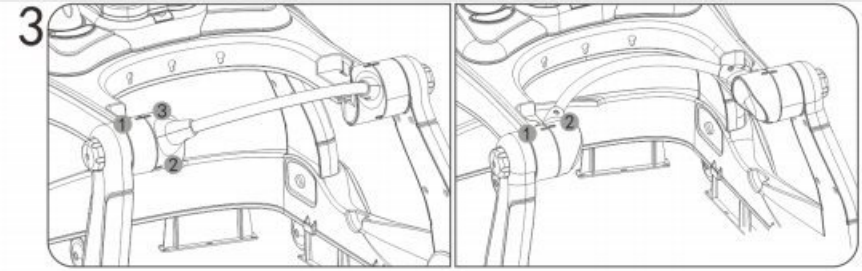

3. Rotate the rear of the seat ring forward until it locks into place, to become the Walk-Behind handle. Your child can now stand behind the walker.

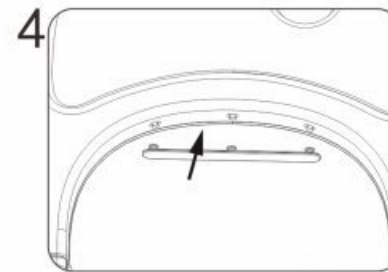

4. Attach fabric cover: Insert the plastic pins on the front of the seat into the holes, then click the pins into position by pushing them downwards.

Dream On Me inc.
125 Helen street
South Plainfield NJ 07080



1532, S. Washington Avenue
Piscataway, NJ 08854
E-mail: info@dreamonme.com

www.dreamonme.com

Follow us on



@dreamonmeinc



@dreamonmeinc

to get your nursery featured on our social media.

Enter our monthly giveaway!

Simply scan the QRcode to register.



Chat with us!

For any questions or concerns or feedback.

