

Drift Rider

Instruction Manual

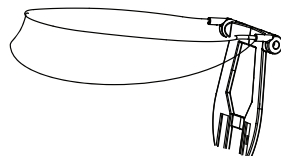

Scan the QR code to register your product
<https://dreamonme.com/customercare/registration/>

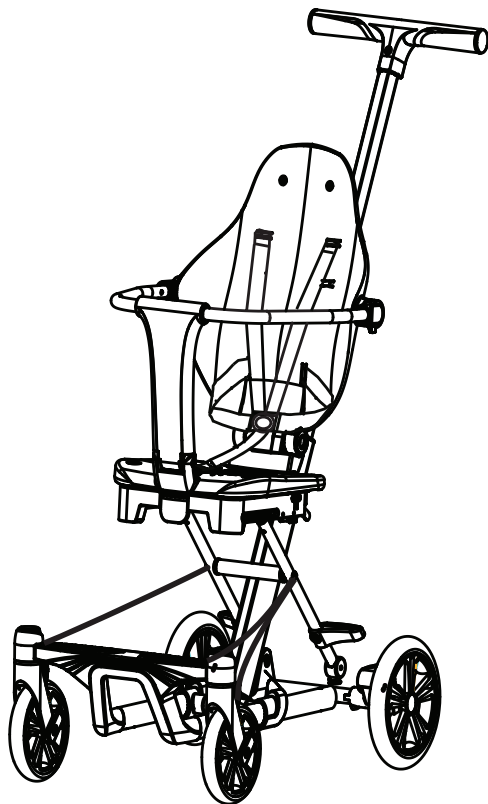

Read all instructions before
assembling and using the product.

IMPORTANT - Keep Instructions
for future use.



WARNING

IMPORTANT!

Failure to follow these warnings and the assembly instructions could result in serious injury or death. **PLEASE SAVE INSTRUCTION MANUAL FOR FUTURE USE.**



WARNING

- **ADULT ASSEMBLY REQUIRED.**
- **NEVER LEAVE CHILD UNATTENDED.** Always keep child in view while in stroller.
- **AVOID SERIOUS INJURY** from falling or sliding out. Always use seat belt. After fastening buckles, adjust belts to get a snug fit around your child.
- **AVOID FINGER ENTRAPMENT:** Use care when folding and unfolding the stroller. Be certain the stroller is fully erected and latched before allowing your child near the stroller.
- **NEVER USE STROLLER ON STAIRS** or escalators. You may suddenly lose control of the stroller or your child may fall out. Also, use extra care when going up or down a step or curb.
- **AVOID STRANGULATION.**
- **DO NOT** place items with a string around your child's neck, suspend strings from this product, or attach strings to toys.
- **USE OF THE STROLLER** with a child weighing more than 45 lb (20.5 kg) or taller than 37.8 in (96cm) will cause excessive wear and stress on the stroller. Use the stroller with only one child at a time.
- **TO PREVENT A HAZARDOUS, UNSTABLE CONDITION,** never place purses, shopping bags, parcels or accessory items on the handle (other than approved stroller bags). Never place anything on the canopy.
- **TO PREVENT A HAZARDOUS, UNSTABLE CONDITION,** do not place more than 10 lb (4.5 kg) total in the storage basket including the 2 lb (1 kg) in the basket pocket.(if supplied)
- **TO AVOID BURNS,** never put hot liquids in the cup holders.(if supplied)
- **NEVER PLACE** child in the stroller with head toward footrest.
- **NEVER ALLOW YOUR STROLLER** to be used as a toy.
- **DISCONTINUE USING YOUR STROLLER** should it become damaged or broken.
- **STROLLER TO BE USED** only at walking speed product not intended for use while jogging, skating, etc.
- **CAREGIVER MUST** always help child get into and out of the stroller.
- **DO NOT** adjust any part while a child in the stroller.

WARNING

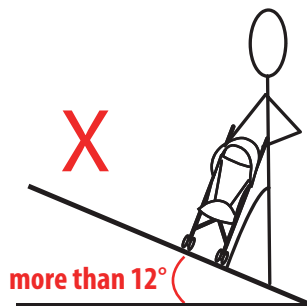
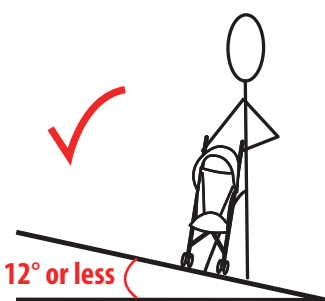

The stroller is designed for use on flat or gently sloping surfaces, and may be adjustable on higher sloping and uneven surfaces. Be aware of the possibility of the rider rolling away or tipping over.

- WITH YOUR HAND THROUGH THE WRIST TETHER STRAP LOOP, PUSH THE RIDER HOLDING BOTH HANDLES.
- THE FRONT WHEELS MAY WOBBLE OR OSCILLATE WHEN WALKING FAST.
- CAUTION IS REQUIRED WHEN PUSHING THE STROLLER ACROSS STEEP SLOPES OR UNEVEN SURFACES THIS MAY CAUSE STROLLER TO BECOME UNSTABLE AND FALL OVER. ALWAYS HOLD THE HANDLES FIRMLY.
- DO NOT RUN WITH THE STROLLER.
- WHENEVER YOU STOP, ALWAYS APPLY THE BRAKES BEFORE YOU LEAVE THE STROLLER.
- DO NOT HANG BAGS OR GOODS FROM THE HANDLE AS THIS COULD CAUSE THE RIDER TO TIP OVER.
- THE STROLLER IS SUITABLE FOR A CHILD FROM 6~36 MONTHS OLD.

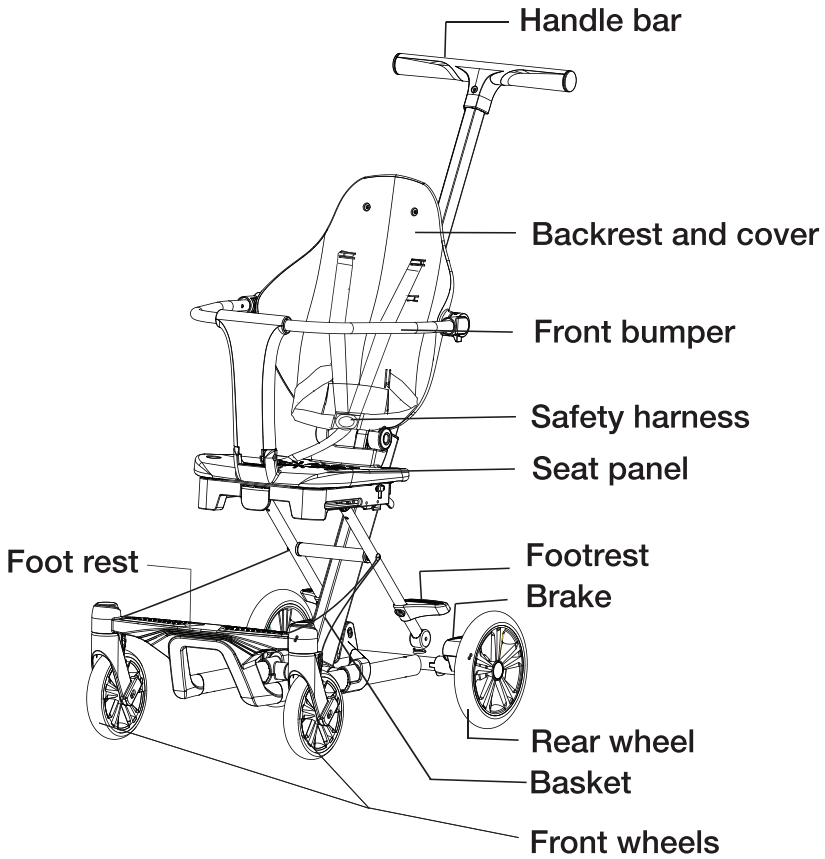

PARTS LIST

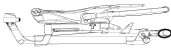

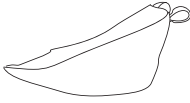
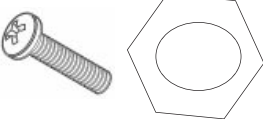
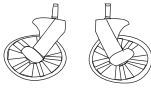
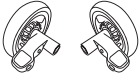
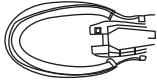
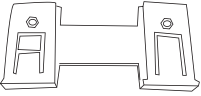
			
Frame	Seat cover	Basket	Nut and Bolt x2
			
Front Wheels	Rear Wheels	Canopy	Canopy mount

ASSEMBLING THE RIDER

1. Pull up the top of the backrest to unfold the seat to the upright position. Figures A & B.

2. Hold the foot rest with one hand and lift the handle of stroller to raise the seat. lift the seat via the handle until it clicks into place. Figures C & D.

CAUTION!

Whenever the rider is opened, make sure that it is latched properly.

3. Slide each of the front wheels into the mounting post until they click into place. Figure E.

To remove the front wheel, push in the wheel release metal pin under footrest and remove the wheel. Figure F.

4. Slide each of the rear wheels into the mounting post until they click into place. Figure G.

CAUTION!

Make sure that the brakes are facing backwards. Figure H.

To remove the rear wheel, push in the wheel release metal pin and remove the wheel. Figure H.

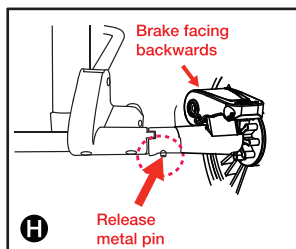
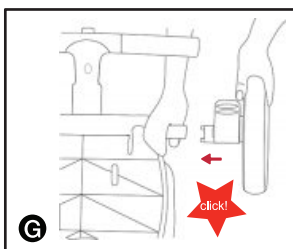
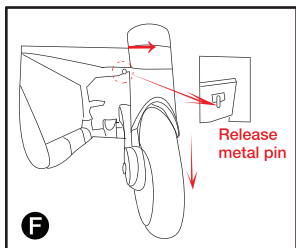
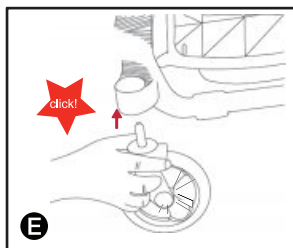
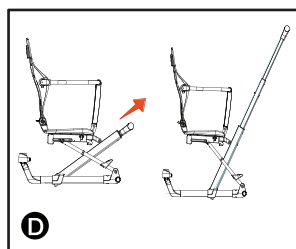
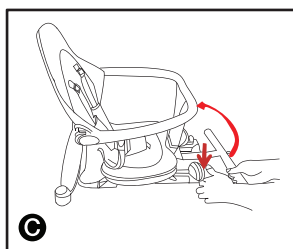
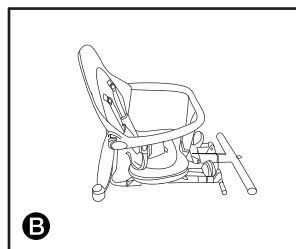
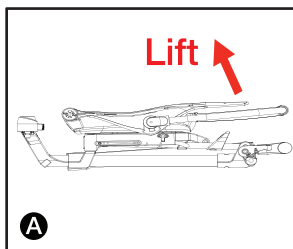

CAUTION!

Pull on each the wheel to make sure that they are attached securely.

CANOPY ASSEMBLY

1. Open the snaps to expose the inside of the seat back. See figure A.

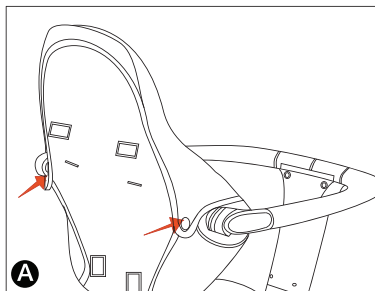

2. Put each nut into the holes on canopy mount. Next, align with the screw holes on the seat back. See figures B and C.

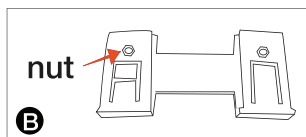

3. After aligning canopy mount with the seat back, screw in the bolt to hold the canopy mount in place. See figures C and D.

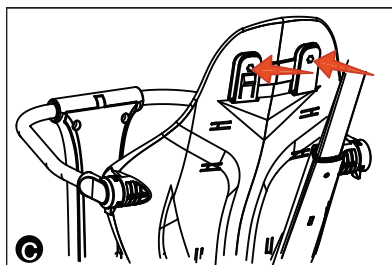

Note: Screw driver not provided.

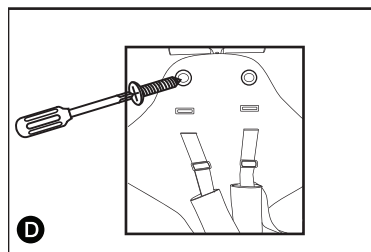

CANOPY INSALLATION

1. To attach the canopy, insert the canopy holder into the slot in the back of the seat. Figures A & B.

CAUTION!

Pull up on the canopy to make sure that it is attached securely.

2. To remove the canopy, press the release button to remove the canopy. Figures C & D.

3. To adjust the canopy, pick up or lower the hanging fabric.

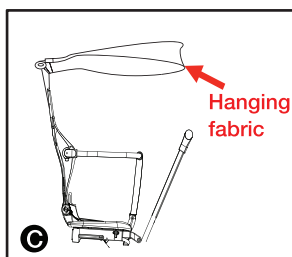
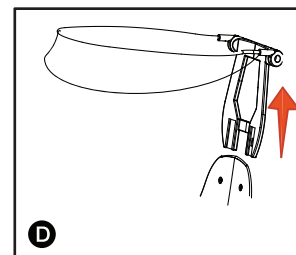
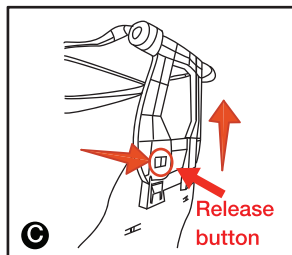
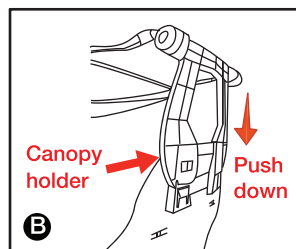
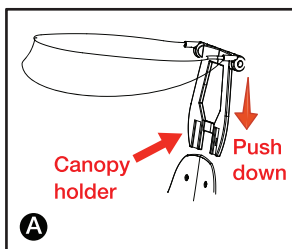

FOLDING THE RIDER

1. Press the handle release button and slide the handle all the way down. Figure A.

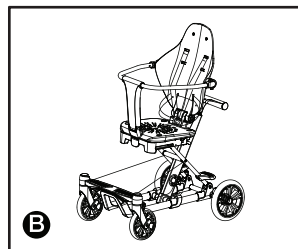
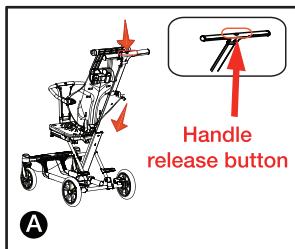

2. Press the second lock and pull up on the red lever to lower the chassis. Figures C & D.

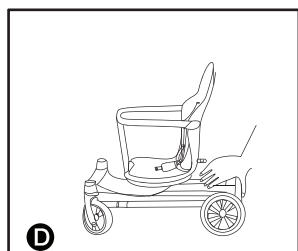
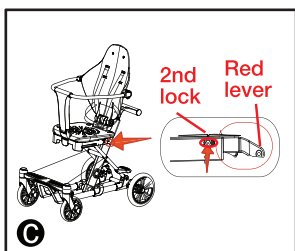

3. Fold over the canopy. Figures E.

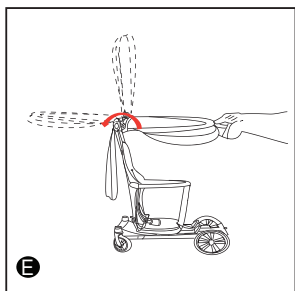

4. Push down the lever behind the seat to fold the seat forward. Figures G & H.

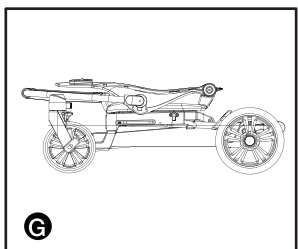
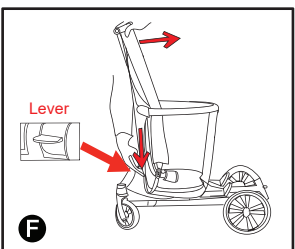

UNFOLDING THE RIDER

1. Pull up the backrest to the upright position and open up the canopy. Figures A & B.

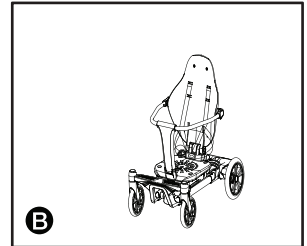
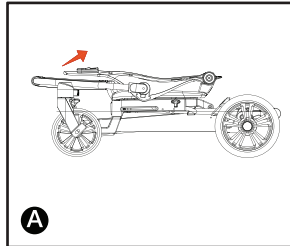

2. Hold down the chassis with one hand and lift the seat with the other hand to open up and erect the seat until it clicks into place. Figures C & D.

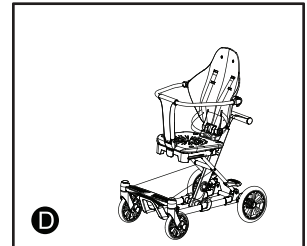
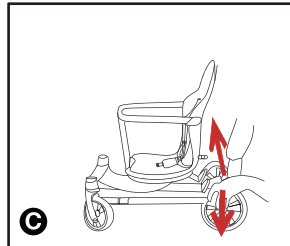

CAUTION!

Whenever the rider is opened, make sure that it is latched properly.

3. Pull up the handle bar until it clicks into place. Figures E & F.

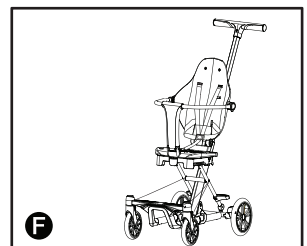
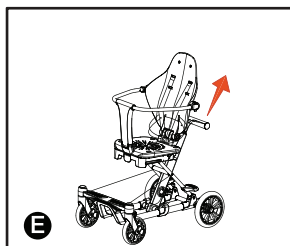

SWIVELING THE SEAT

Pull the lever to swivel the seat to face frontwards or backwards. Figures A & B.

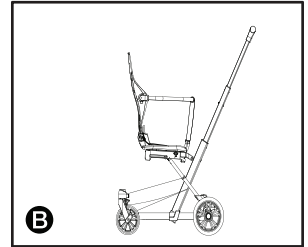
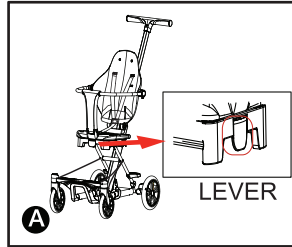

USING THE BRAKES

Pushing the brakes down will brake the rider.

Lifting the brakes up will release the brakes of the rider. Figures C & D.

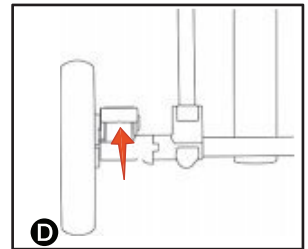
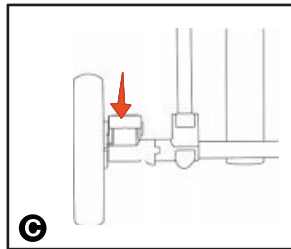

⚠ WARNING: ALWAYS APPLY THE BRAKES WHEN THE STROLLER IS STATIONARY.

USING THE HARNESS

WARNING: USE THE HARNESS AT ALL TIMES.

When not in use, disconnect shoulder straps from the waist strap and buckle to prevent strangulation.

A five point harness is provided to restrain your child. Buckle tongues separate for added safety. To reconnect buckle tongues and to secure the child in the harness please follow the steps below carefully.

1. Position the shoulder strap tongue (1) on the top of the waist buckle tongue (2) on both sides. Figure A.

2. Push both buckle tongues (1+2) into the buckle housing (3) until the buckle tongues lock into position. Figure B.

3. Tighten or loosen the crotch straps by sliding the 3 bar sliders up and down. To tighten or loosen the waist straps, hold and slide the 3 bar sliders along the strap and then pull the harness strap. The waist strap needs to fit firmly around the child. Figure C.

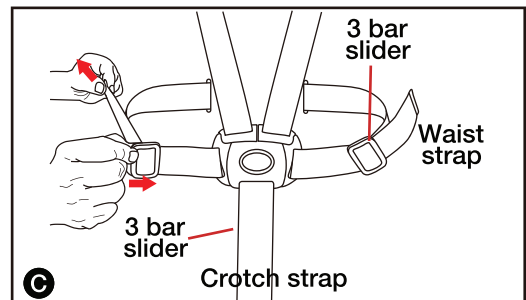
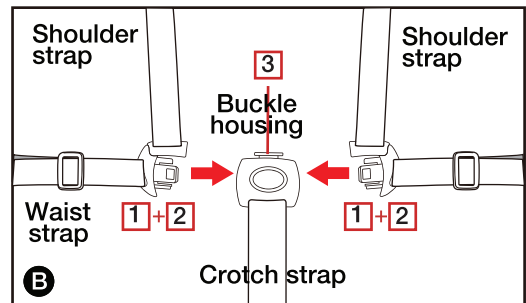
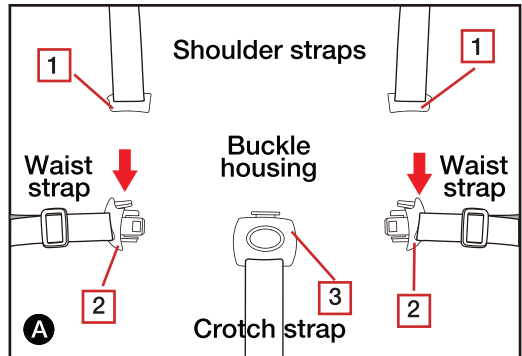

USING THE HARNESS (continued)

4. To tighten or loosen the shoulder strap, hold and lift the slider and then pull the harness strap to adjust to the desired fit. The waist strap needs to fit firmly around the child. Figure D.

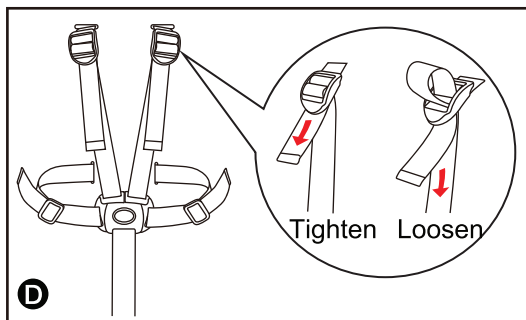

5. To release the buckle, squeeze the button in the center of the buckle housing to release the buckle tongues. Figure E.

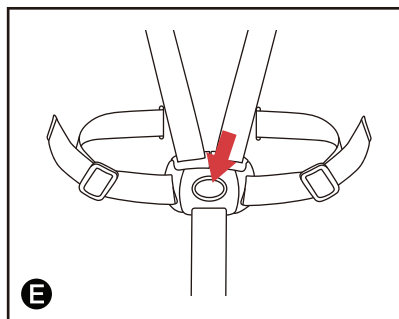

6. The stroller seat has 2 sets of harness slots at different heights to accommodate the height of your child. Figures F1-F4.

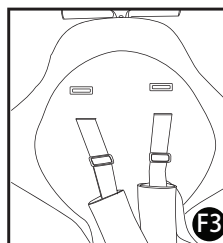
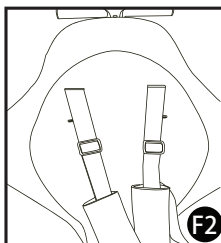
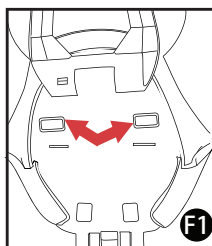



CARE AND MAINTENANCE

- To prolong the life of your stroller keep it clean and do not leave it in the direct sunlight or in the car boot for extended periods of time.
- Removable fabric covers and trims may be cleaned using warm water with a household soap or mild detergent. Allow it to dry fully, preferably away from the direct sunlight.
- Non removable fabric covers and trims may be spot cleaned using a damp sponge with soap or a mild detergent. Allow it to dry completely before folding or storing it away.
- In some climates the covers and trims may be affected by mold and mildew. To help prevent this occurring, do not fold or store the product if it is damp or wet.

Always store the product in a well ventilated area.

- When using your stroller at the beach - completely clean your stroller afterwards to remove the sand and salt from the mechanisms and wheel assembly. Sand and salt will cause premature wear and corrosion.
- If there are compression marks on the wheels - Use a domestic hair dryer to gently warm (DO NOT OVERHEAT) the wheels and the compression marks should slowly disappear.
- Always check parts regularly for tightness of screws, nuts, and other fasteners. Tighten if required. To maintain the safety of your nursery product, seek prompt repairs for bent, torn, worn or broken parts.



Dream On Me Inc.
1532 S Washington Ave,
Piscataway Twp. NJ 08854



1532 S. Washington Avenue
Piscataway, NJ 08854
E-mail: info@dreamonme.com

www.dreamonme.com

Follow Us @dreamonmeinc
to get your nursery featured on our social media.



Enter our monthly giveaway!
Scan the QRcode to register.



Chat with us!
Scan the QRcode to Live Chat.

