

Dream On Me Inc.
1532 S Washington Ave
Piscataway Township
NJ 08854

Email: info@dreamonme.com
www.dreamonme.com



ASSEMBLY INSTRUCTIONS

STYLE NO: 598

Scan the QR code to register your product
<https://dreamonme.com/customercare/registration/>



REF.	PART NAME	QUANTITY
A	Connection Panel	1
B	Left Panel	1
C	Right Panel	1
D	Front Top Rail	1
E	Front Bottom Rail	1
F	Back Top Rail	1
G	Back Bottom Rail	1
H	Back Panel	2
J	Back Middle Rail	1
DR1	Front panel	5
DR2	Side panel	10
DR3	Back panel	5
DR4	Bottom panel	5
DR5	Bottom support panel	5
a	3" bolt	12
b	barrel nut	12
c	cams	5
d	cam bolts	5
e	1" screw	45
f	1-3/5" wood dowel	6
g	knob	10
h	1" screw	10
i	allen wrench	1
j	tip over restraint	2

WARNING

Read all instructions before assembling. Save instructions for future use. Carefully remove and lay out all parts. Familiarize yourself with all diagrams to facilitate the assembly of your product. Check parts and the enclosed hardware bag with the hardware parts list to be sure all are included and quantities are correct. Destroy cardboard and plastic bags immediately.

Attention: In order to properly assemble the chest, follow the assembly instructions carefully. Failure to assemble in the manner recommended could make the chest hazardous.

Warning: Never use this product if there are any loose or missing fasteners, loose joints, broken parts, or torn mesh/fabric. Check before assembly and periodically during use. Contact Dream On Me for replacement parts and instructional literature if needed.

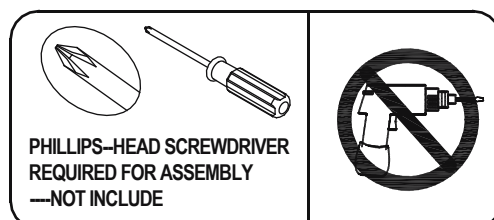
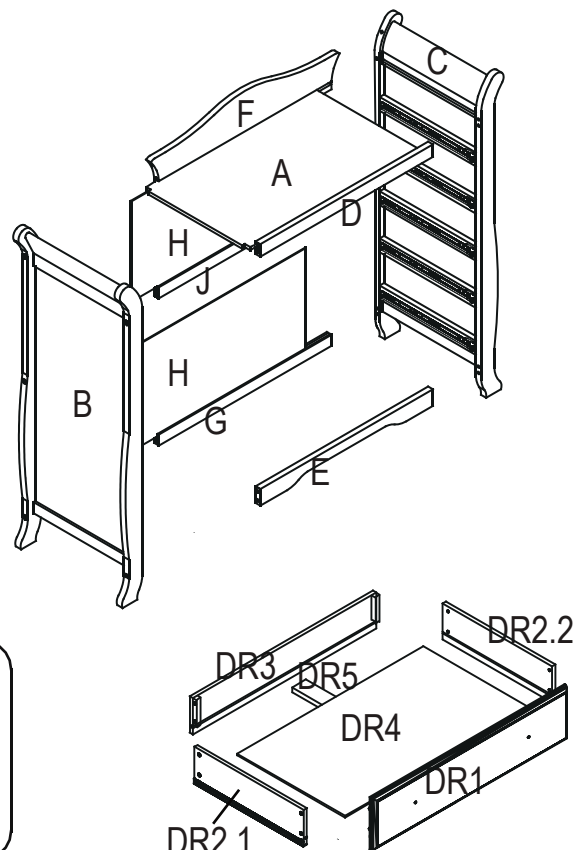
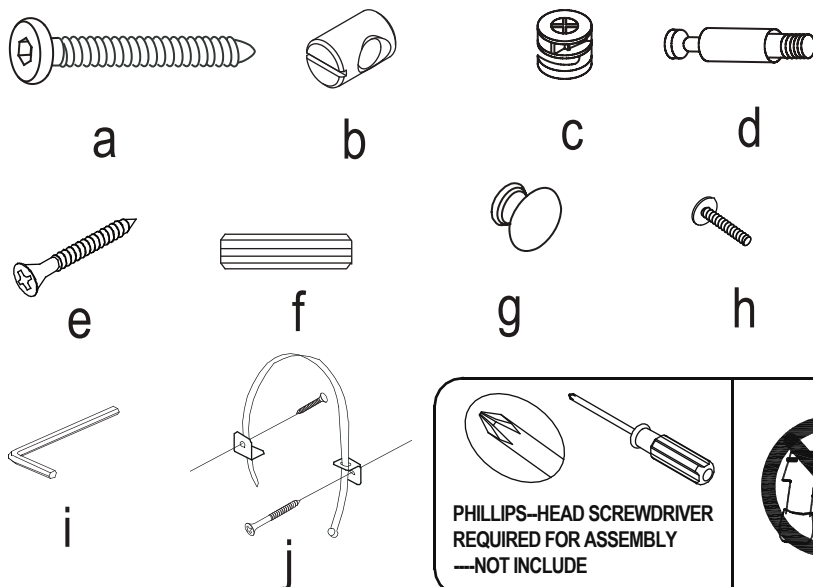

STEP 1

Use allen wrench (i) to connect bolts. Connect front top rail (D), front bottom rail (E), back top panel (F), back bottom rail (G) and back middle rail (J) to right panel (C) by using 3" bolt (a), barrel nut (b) and 1-3/5" wood dowel (f).

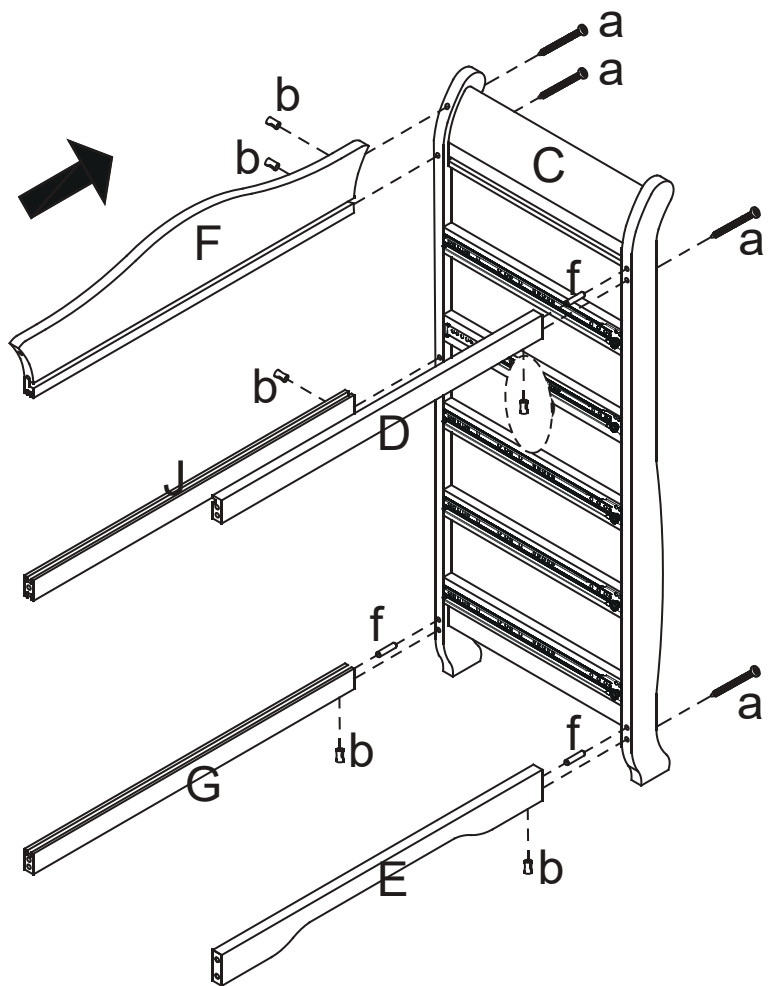

STEP 2

Lay down the assembled parts on the floor. Slide the connection panel (A) into the grooves on back top panel (F) and front top rail (D). Slide the back panel (H) into the grooves on back top panel (F), back bottom rail (G) and back middle rail (J).

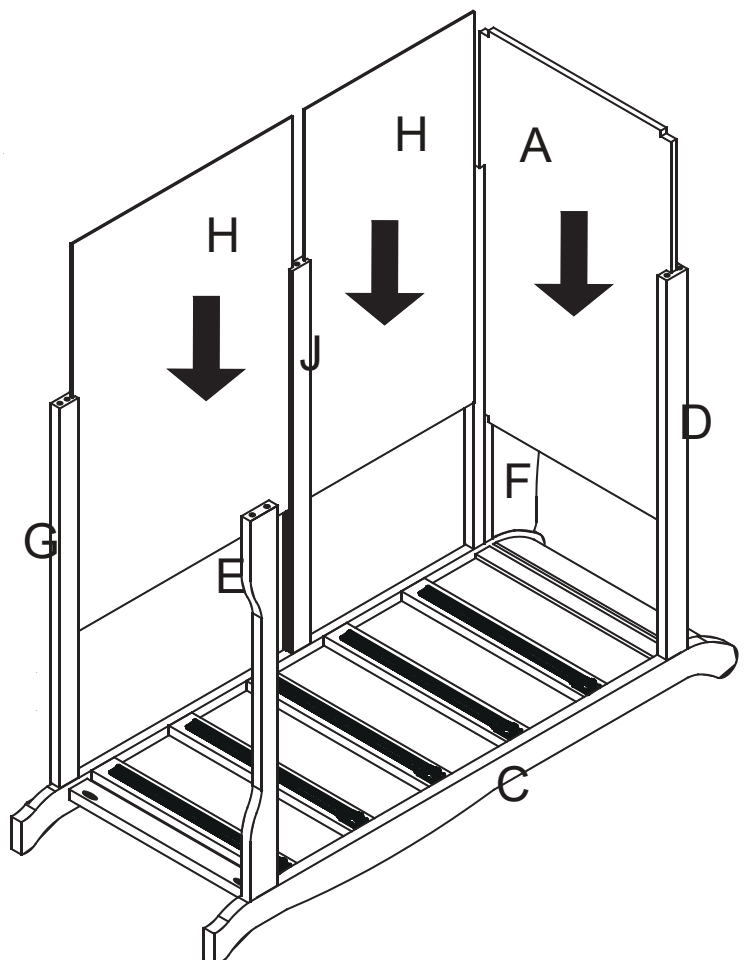

STEP 3

Assemble the left panel (B) to the assembled parts of STEP 2 use the same way as shown in STEP 1.

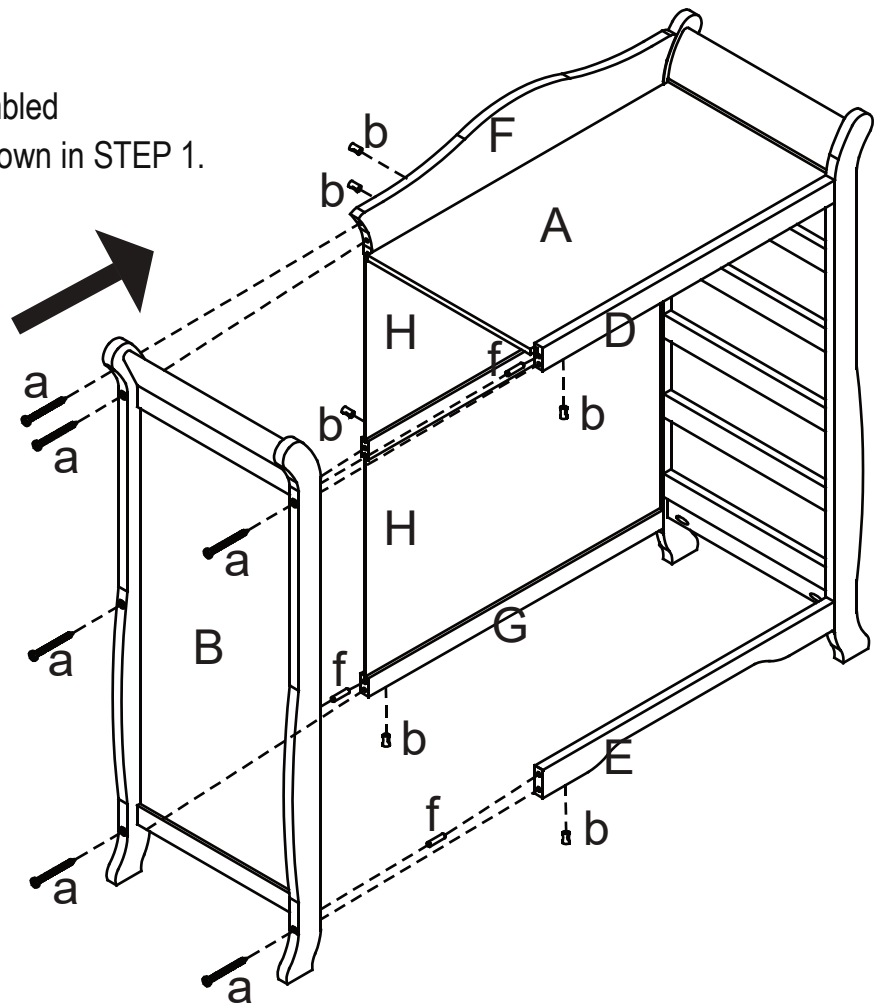

STEP 4

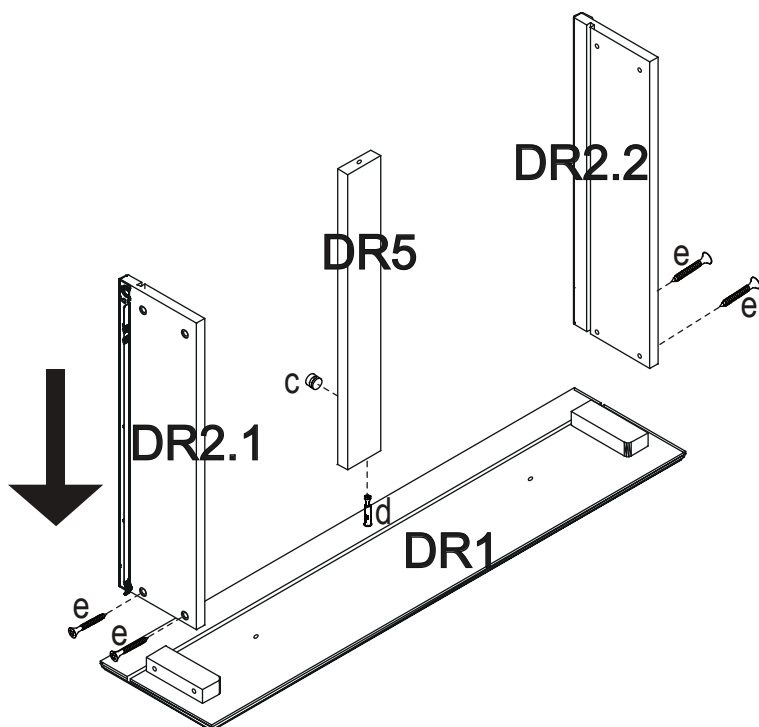

Connect side panel (DR2) to front panel (DR1) by using 1" screw (e) .

Connet bottom support panel (DR5) to front panel (DR1) by using cams (c) and cam bolts (d).

MAKE SURE the grooves line up and face inside.

LOCK cams (c) into bottom support panel (DR5) by turning them.

USE allen wrench (m) to tighten 1" screw (e).

STEP 5

Slide bottom panel (DR4) painted side up , into grooves of front panel (DR1) and side panel (DR2) .

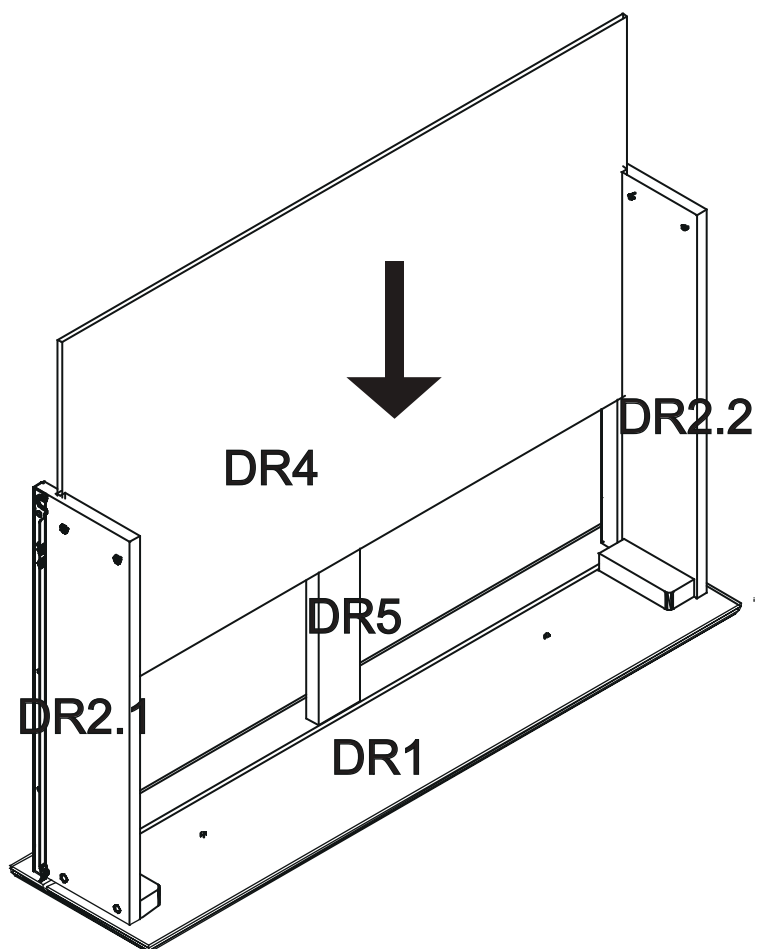

STEP 6

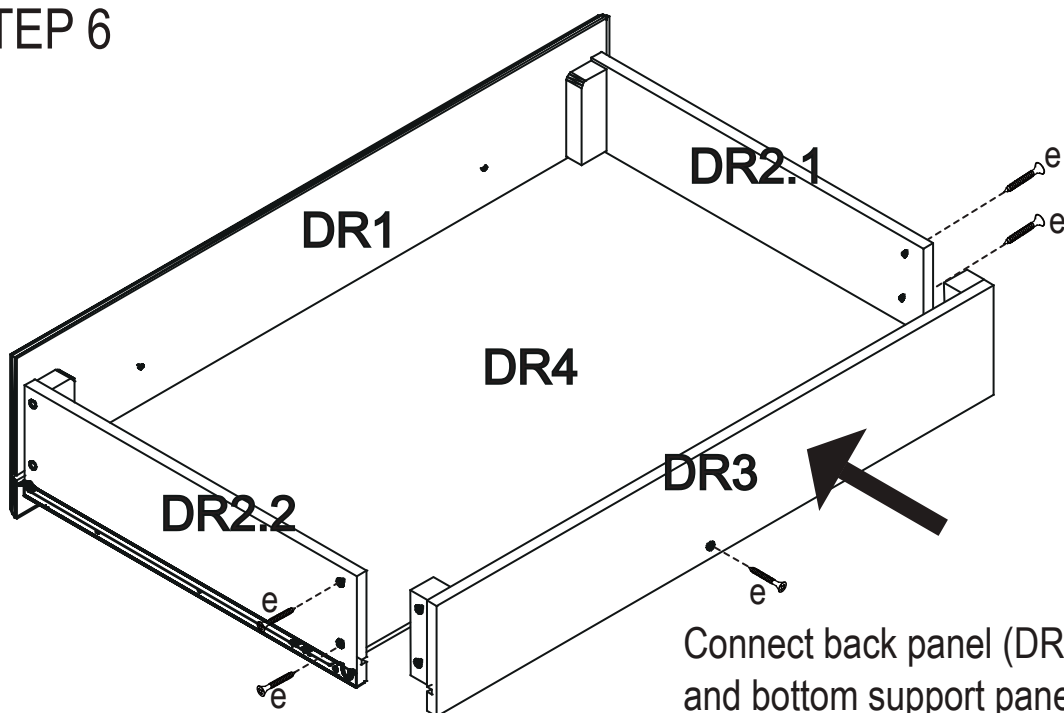

Connect back panel (DR3) to side panel (DR2) and bottom support panel (DR5) by using 1" screw (e).
TIGHTEN all by allen wrench (m) .
ASSEMBLE the rest of drawers by repeating STEP 4,5,6.

STEP 7

Connect the knob (g) to front panel (DR1) by using 1" screw (h) .

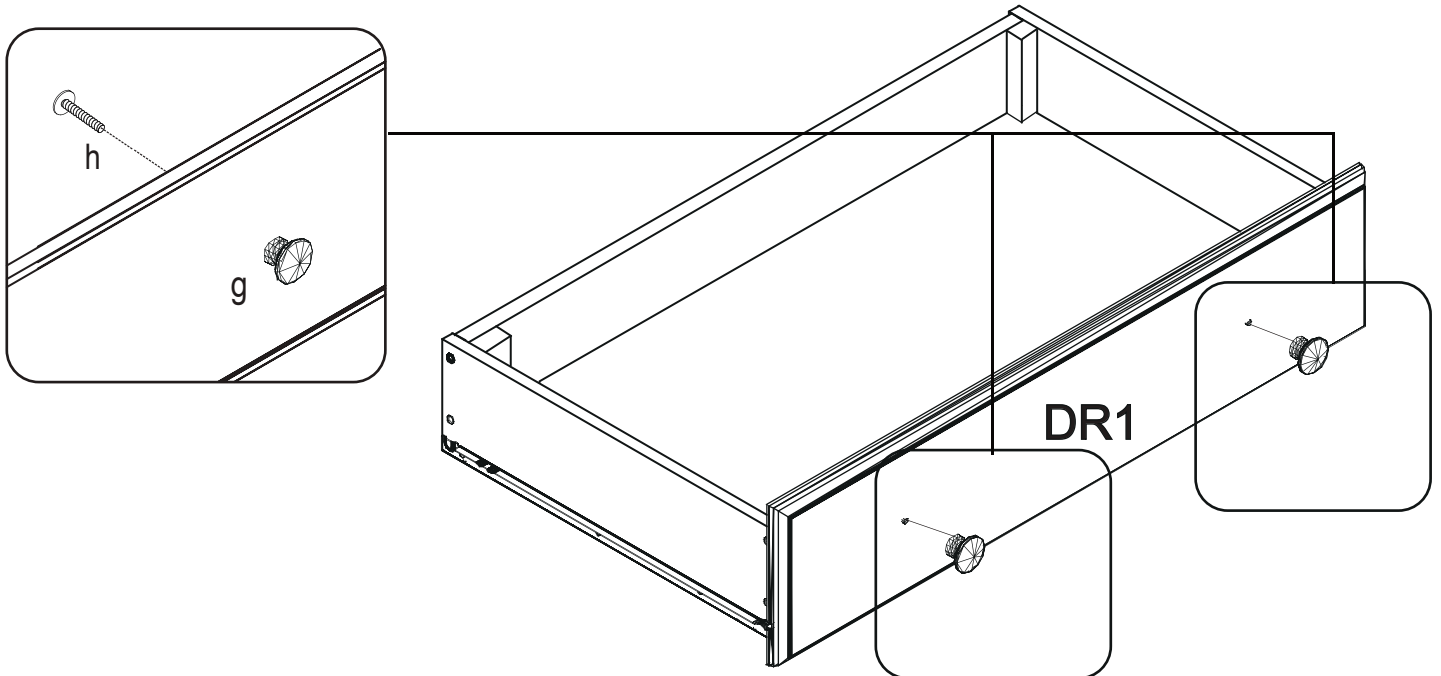

STEP 8

Slide the drawers into rails on left&right panel (B&C) .

NOTE: PLEASE PUT THE DRAWER WITH CLEAN STICKER AS THE TOP ONE .

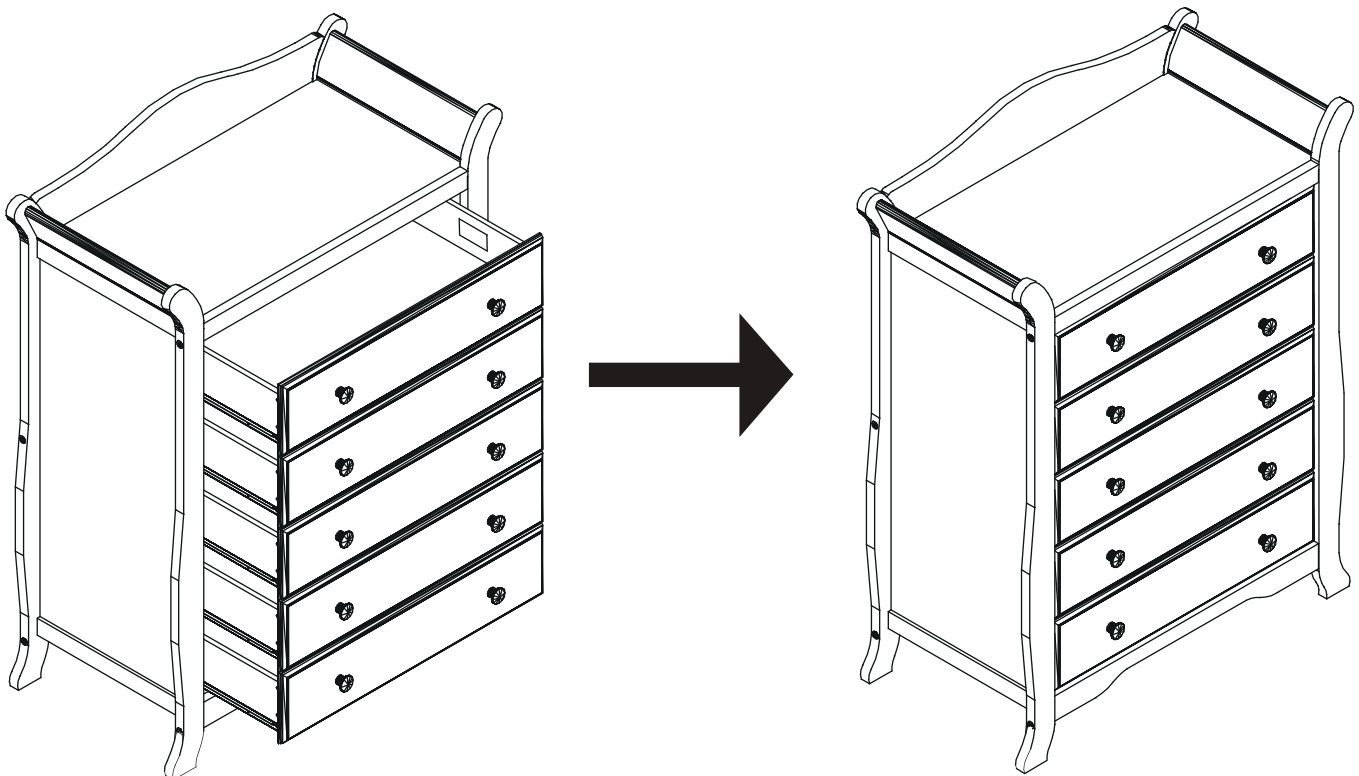

FURNITURE TIPPING DETERRENT HARDWARE

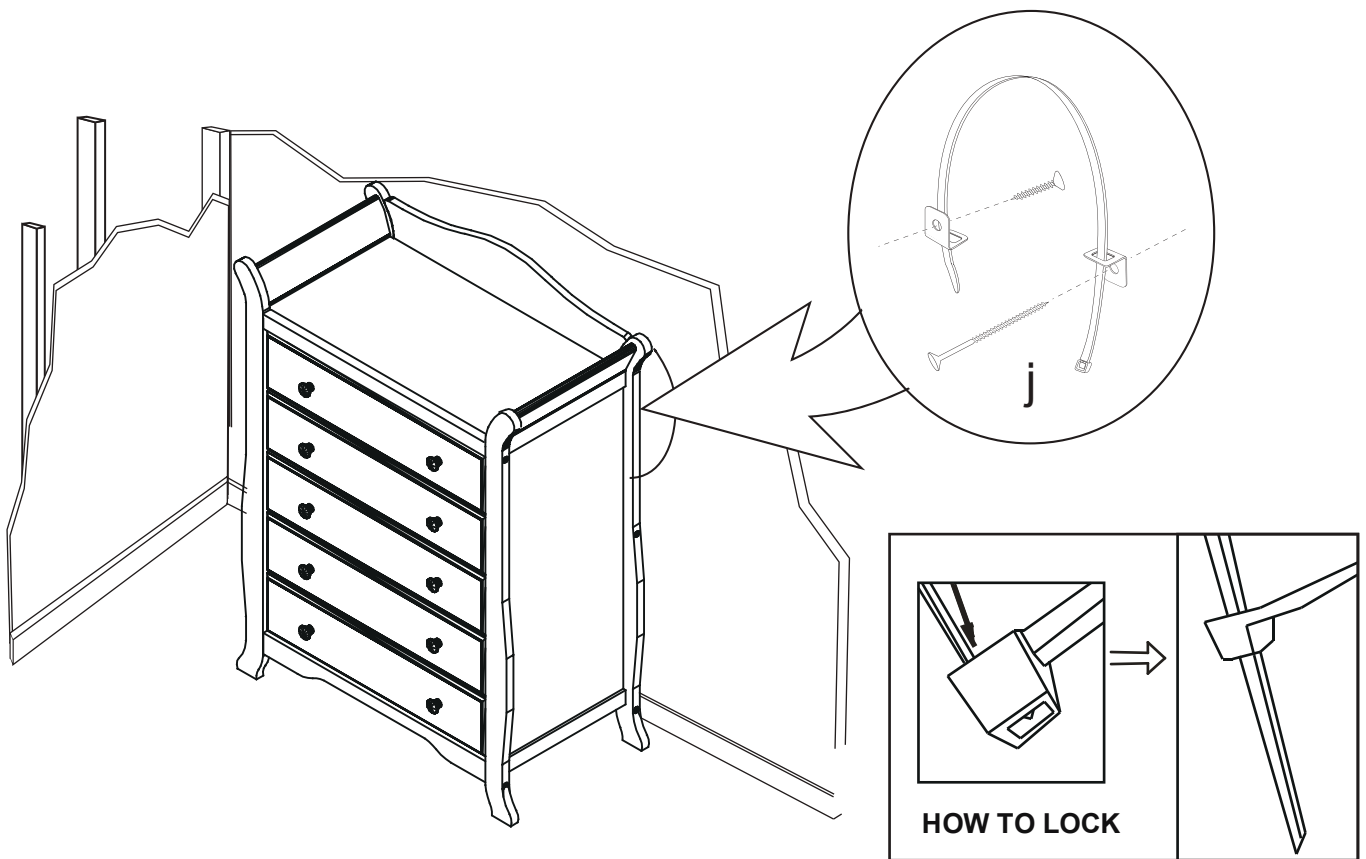

Tipping furniture may injure young children. Use of this tipping restraint hardware is highly recommended.

When properly instated this hardware could provide protection against the unexpected tipping of furniture due to improper use.

WARNING

This hardware is only a deterrent. Adult supervision is the only proper deterrent to prevent improper use of any potentially hazardous product.

1. Attach one of the mounting brackets securely to the back top edge of the furniture using the short screw.
2. Find the stud in the wall and mark the location on the wall for mounting the second bracket using a 2" wood screw approximately 2" below the bracket mounted to the edge of the furniture.
3. If a stud cannot be found, purchase a "Hollow-Wall Anchor Bolt" and attach the second bracket to the wall using that bolt. Make sure to follow all instructions by the manufacturer.
4. Place the furniture so the bracket on the back edge is in line with the bracket on the wall.
5. Lace an end of the nylon restraint strap down through each bracket. Bring both ends together and slide the beaded end of the strap through the key hole shaped slot in the other end tightly. Pull down on the beaded end until it snaps locks into the keyhole.
6. Check to make sure the strap is securely laced and locked to the brackets.

MADE IN CHINA



1532, S. Washington Avenue
Piscataway, NJ 08854
E-mail: info@dreamonme.com

www.dreamonme.com

Follow us on



@dreamonmeinc



@dreamonmeinc

to get your nursery featured on our social media.

Enter our monthly giveaway!

Simply scan the QRcode to register.



Chat with us!

For any questions or concerns or feedback.



DOM
FAMILY

