

# Manual for baby bassinet

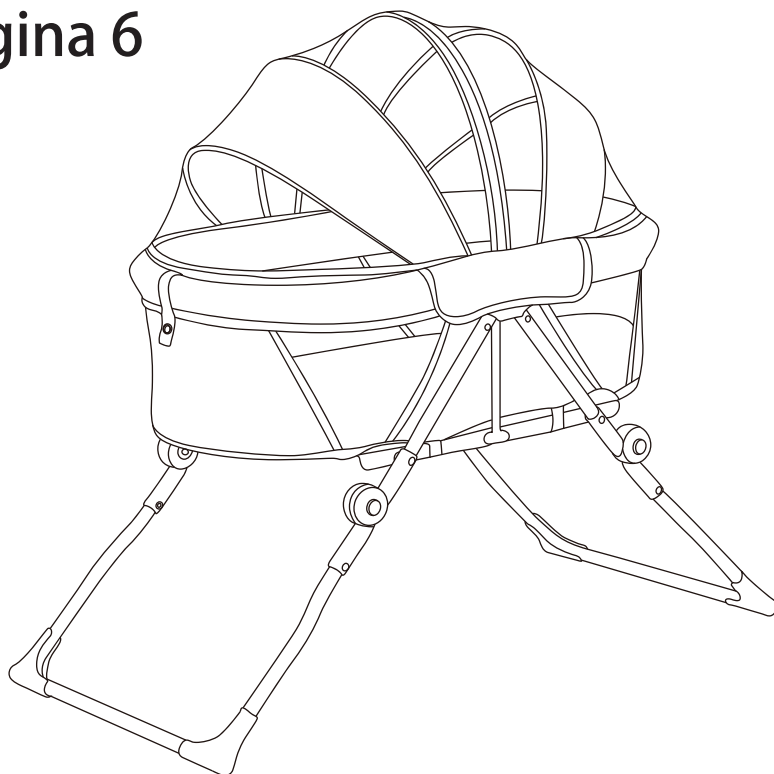

Para español  
Ver página 6



Scan the QR code to register your product  
<https://dreamonme.com/customer-care/registration/>



**ITEM NO.:#4471**

## **WARNING:**

Failure to follow these warnings and the instructions could result in serious injury or death.

**FALL HAZARD** - To help prevent falls, do not use this product when the Infant begins to push up on hands and knees or has reached 25lbs weight or up to 3 months, whichever comes first.

## **WARNING:**

# SUFFOCATION HAZARD

## Infants have suffocated:

- In gaps between an extra padding and side of the bassinet
- On soft bedding.

Use **ONLY** the mattress pad provided by Dream On Me.

**NEVER** add a pillow, comforter, or another mattress for padding.

To reduce the risk of SIDS, pediatricians recommend healthy infants be placed on their backs to sleep, unless otherwise advised by your physician.

If a sheet is used with the pad, use only the one provided by Dream On Me to fit the dimensions of the bassinet mattress.

Strings can cause strangulation! Do not place items with a string around a child's neck, such as hood strings or pacifier cords. Do not suspend strings over a bassinet or cradle or attach strings to toys.

## **Maintenance & Cleaning:**

- Please make a routine check to make sure that the bassinet is secure.
- Please use a soft dry cloth or sponge to clean the bassinet. Do not use alkaline or acidic solutions to clean the bassinet in order to prevent the frame from corroding.
- do not use or store the bassinet in a wet, cold, or high temperature environment for a long period of time.

**Dream On Me Inc.**  
**1532 S Wasington Ave, Piscataway TWP, NJ**  
**08854**  
**MADE IN CHINA**

Thank you for choosing Dream On Me and congratulations on joining The DOM Family, a family that has been transforming lives for 30 years! We appreciate your feedback and wish you the very best in the coming years with your new addition. If you have any questions or concerns please don't hesitate to reach out and a trusted DOM representative will assist you. Thank you again for entrusting us to supply you with the safest, functional and affordable baby products and accessories. Feel free to follow us on Facebook and Instagram for further opportunities and offers.

## Parts List

Please check to make sure that all of the following parts listed are included in the box when opened. If there are any missing parts, please Dream On Me before using the product.



## Opening up the bassinet



2. Lift the handrails on both sides of the bassinet to open it completely. Arrange the fabric cover neatly on both sides of the bassinet.



## Closing steps

1. Remove the hook and loop fasteners from the fabric covering on both sides of the top rail.



2. Press the joint button and fold both sides of the bassinet inward.



3. Press the bassinet leg-joint button to fold in the legs.



## Using the Canopy

1. The canopy can be opened and closed using the zipper.

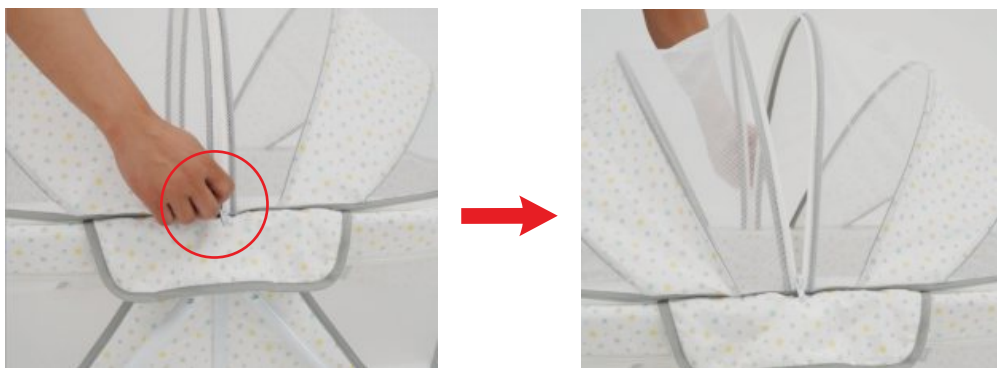

2. When the canopy is not in use, the canopy can be opened up and locked into place with the snaps on both sides of bassinet.

**WARNING:** allowing the canopy to droop into the bassinet can pose as a choking hazard for your baby.



Thank you for choosing Dream On Me and congratulations on joining The DOM Family, a family that has been transforming lives for 30 years! We appreciate your feedback and wish you the very best in the coming years with your new addition. If you have any questions or concerns please don't hesitate to reach out and a trusted DOM representative will assist you. Thank you again for entrusting us to supply you with the safest, functional and affordable baby products and accessories. Feel free to follow us on Facebook and Instagram for further opportunities and offers.

## Lista de partes

Please check to make sure that all of the following parts listed are included in the box when opened. If there are any missing parts, please Dream On Me before using the product.

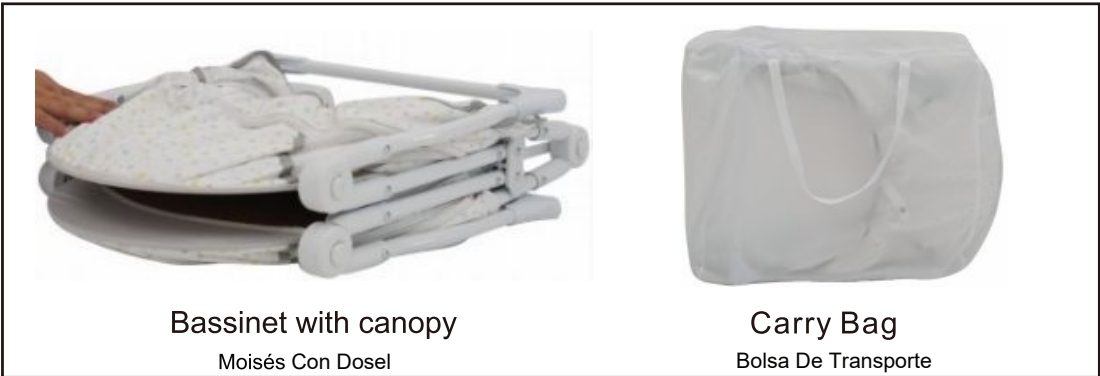

## Abrir la cuna



2. Levante los pasamanos a ambos lados del moisés para abrirlo por completo. Coloca la funda de tela de forma ordenada a ambos lados del moisés.



## Pasos De Cierre

1. Quite los sujetadores de velcro de la tela que cubre a ambos lados del riel superior.



2. Presione el botón de unión y doble ambos lados del moisés hacia adentro.



3. Presione el botón de articulación de la pierna del moisés para doblar las piernas.



## Uso Del Dospel

1. El dosel se puede abrir y cerrar con el zipper.

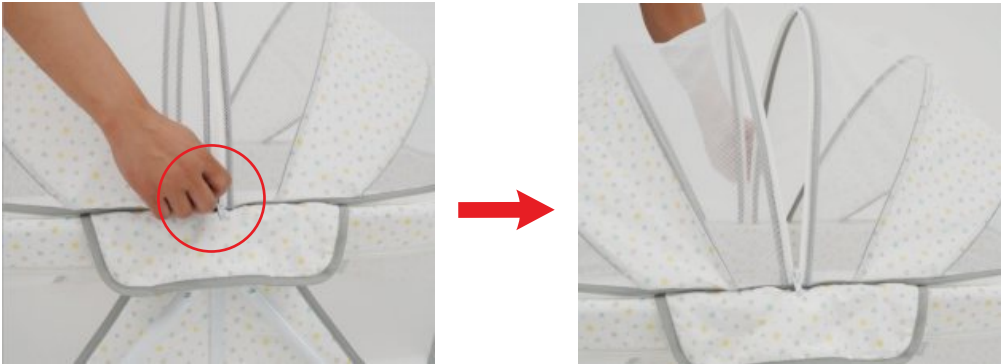

2. Cuando el dosel no está en uso, el dosel se puede abrir y bloquear en su lugar con los broches en ambos lados del moisés.  
**ADVERTENCIA:** permitir que el dosel se caiga sobre el moisés puede representar un peligro de asfixia para su bebé.





1532, S. Washington Avenue  
Piscataway, NJ 08854  
E-mail: [info@dreamonme.com](mailto:info@dreamonme.com)

[www.dreamonme.com](http://www.dreamonme.com)

Follow us on



[@dreamonmeinc](https://www.facebook.com/dreamonmeinc)



[@dreamonmeinc](https://www.instagram.com/dreamonmeinc)

to get your nursery featured on our social media.

Enter our monthly giveaway!

Simply scan the QRcode to register.



Chat with us!

For any questions or concerns or feedback.



DOM  
FAMILY



slumber baby

sweetpea baby

évolur  
evolving with your baby