

# Manual for Lacy Bassinet

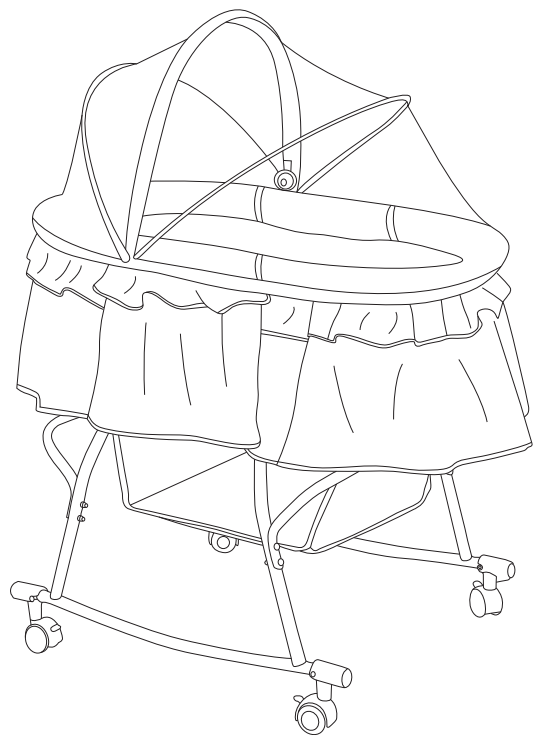

ITEM NO.: #442



Thank you for choosing Dream On Me and congratulations on joining The DOM Family, a family that has been transforming lives for 30 years! We appreciate your feedback and wish you the very best in the coming years with your new addition. If you have any questions or concerns please don't hesitate to reach out and a trusted DOM representative will assist you. Thank you again for entrusting us to supply you with the safest, functional and affordable baby products and accessories. Feel free to follow us on Facebook and Instagram for further opportunities and offers.

## PARTS

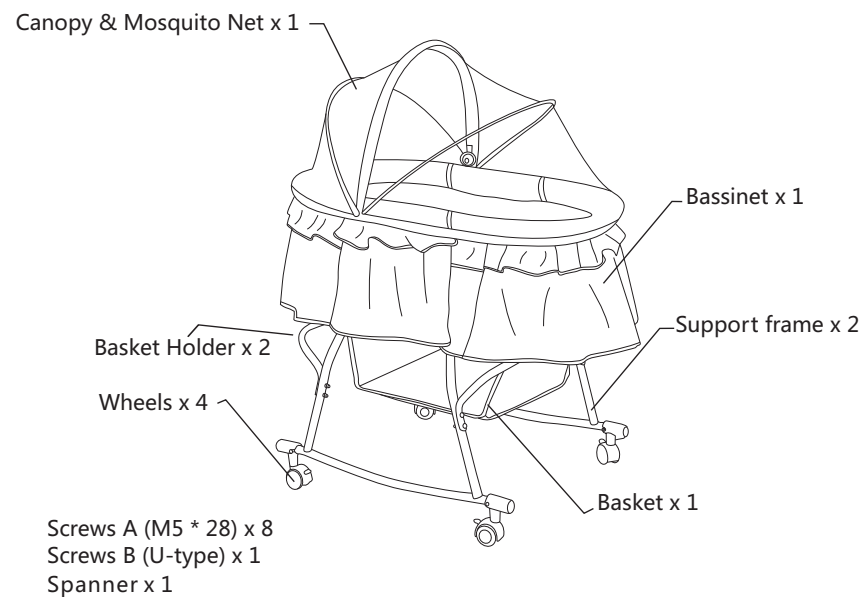

## ASSEMBLY INSTRUCTIONS

Please visit [DreamOnMe.com](http://DreamOnMe.com) for a complete video tutorial of instructions if needed.

### STEP 1. Support frame

Take the basket and slip in through the 2 basket holders. Then, screw them onto the 2 support frames using Screws A and Spanner (see Fig. 1 and Fig. 2).

**Notice: secure all screws tightly using the spanner before use.**

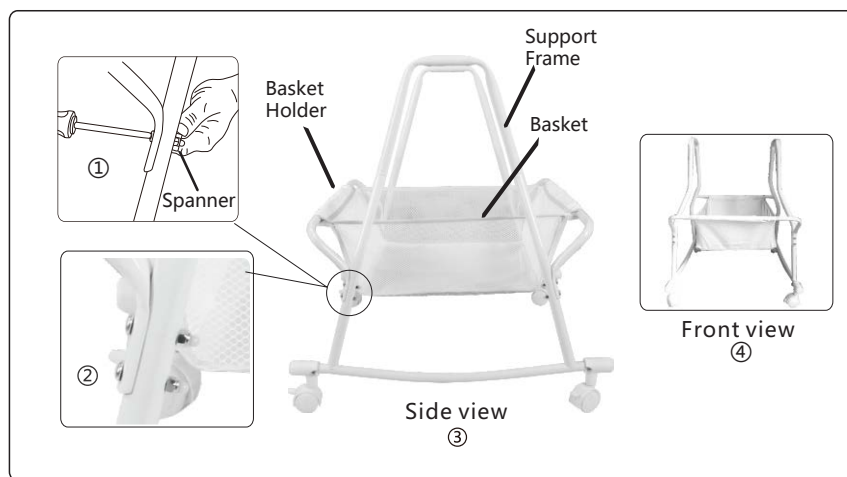

## ASSEMBLY INSTRUCTIONS

### STEP 2. Bassinet

1. Remove the bassinet and connect tube A and tube B as shown below in Fig 1 and 2.
2. Insert screw B (U-type) into the holes of tube A and B as shown in Fig 3 and 4 below.

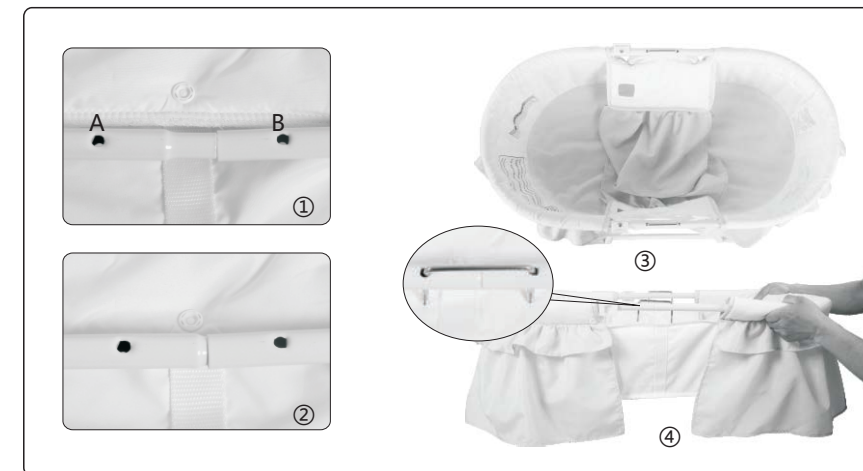

### STEP 3

Put the bassinet onto the support frame and secure all of screws tightly, as shown below.

Notice: secure all of the screws tightly using the spanner before use.

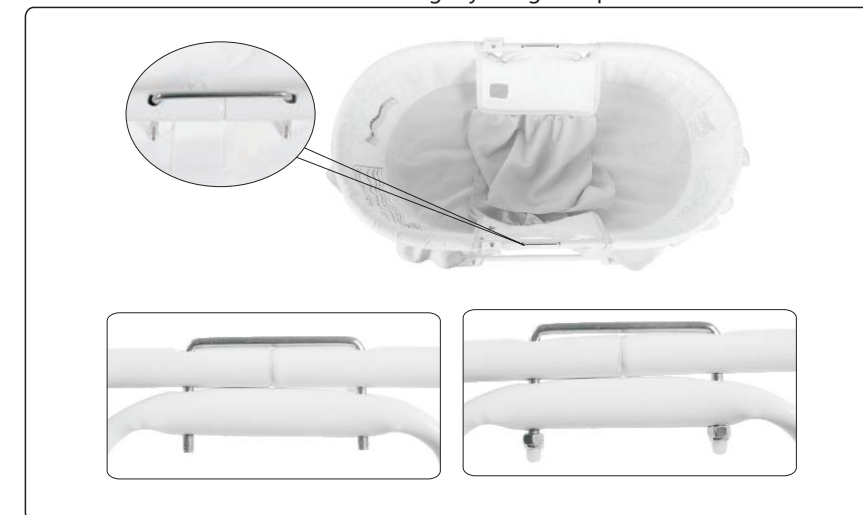

### STEP 4

1. Button the snaps (x4) on each side of bassinet to cover the U-type screws as shown in Image 1.
2. Place the pad inside of the bassinet.



### STEP 5

1. Insert the clip into the lock on both sides of the bassinet to attached the mosquito net as shown in Fig 1 and 2.
2. Button the snap at the back of the canopy to the back of the bassinet as shown in Fig 3.



### STEP 6

Pull on each wheel and turn in 180 degrees to switch between rocking and wheels position.

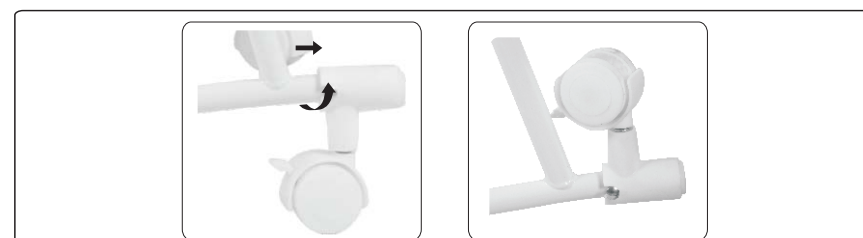

## ⚠ WARNING:

Failure to follow these warnings and instructions could result in serious injury or death. **FALL HAZARD**-To help prevent falls, do not use this product when the infant begins to push up on hands and knees or has reached 25lbs weight or 3 months old, whichever comes first.

## ⚠ WARNING:

# SUFFOCATION HAZARD!

## Infants have suffocated:

- In gaps between an extra padding and side of the bassinet / cradle, and
- On soft bedding.

Use **ONLY** the pad provided by manufacturer. **NEVER** add a mattress, pillow, comforter, or another mattress for padding.

If a sheet is used with the pad, use only the one provided by the bassinet manufacturer to fit the dimensions of the bassinet mattress.

## ⚠ WARNING:

To reduce the risk of SIDS, pediatricians recommend healthy infants be placed on their backs to sleep, unless otherwise advised by your physician.

## ⚠ WARNING:

Strings can cause strangulation! Do not place items with a string around a child's neck, such as hood strings or pacifier cords. Do not suspend strings over a bassinet or cradle or attach strings to toys.

## Maintenance & cleaning:

Please check and maintain the bassinet regularly. An **Adult must check the bassinet to make sure that it is safe at all times.**

### Washing

The soft cover can be removed for washing. Simply unzip and remove the cover from the board

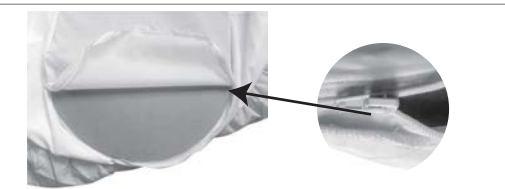

Please use a soft cloth or sponge to clean the bassinet. Do not use alkaline or acidic cleaning products to wash the bassinet to avoid any water damage to the metal frame or hardware. Do not use or keep the bassinet in a wet, cold, or high temperature environment for a long time. Please use the brush or other clean tools to clean the stains on the mattress pad.

Dream On Me Inc.  
1532 S Washington Ave  
Piscataway TWP NJ 08854  
TEL: 732-752-7220 FAX: 732-752-7221