

## Baby Rocker

MODEL NO.: 380  
**USER MANUAL**

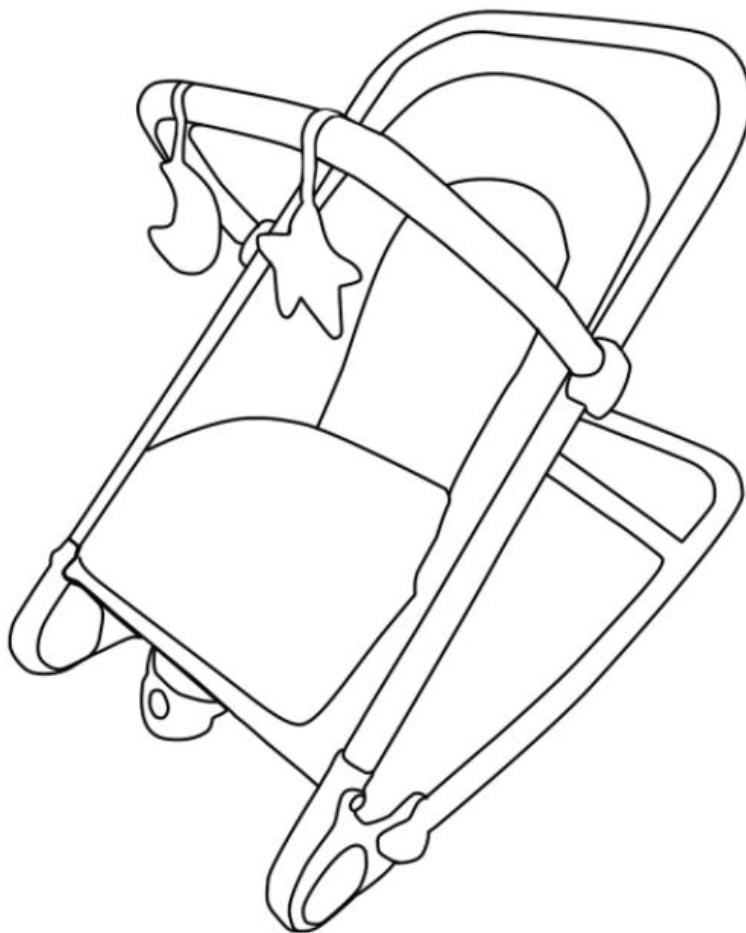

Please read the following instructions and warnings before assembly and each use. KEEP THIS INSTRUCTION MANUAL FOR FUTURE REFERENCE.

Safety • Cozy • Fashion

## Parts List

Please check to make sure that all of the following parts listed below are included in the box when opened. If there are any missing parts, please contact Dream On Me before using the product.

Thank you for choosing Dream On Me and congratulations on joining The DOM Family, a family that has been transforming lives for 30 years! We appreciate your feedback and wish you the very best in the coming years with your new addition. If you have any questions or concerns please don't hesitate to reach out and a trusted DOM representative will assist you. Thank you again for entrusting us to supply you with the safest, functional and affordable baby products and accessories. Feel free to follow us on Facebook and Instagram for further opportunities and offers.

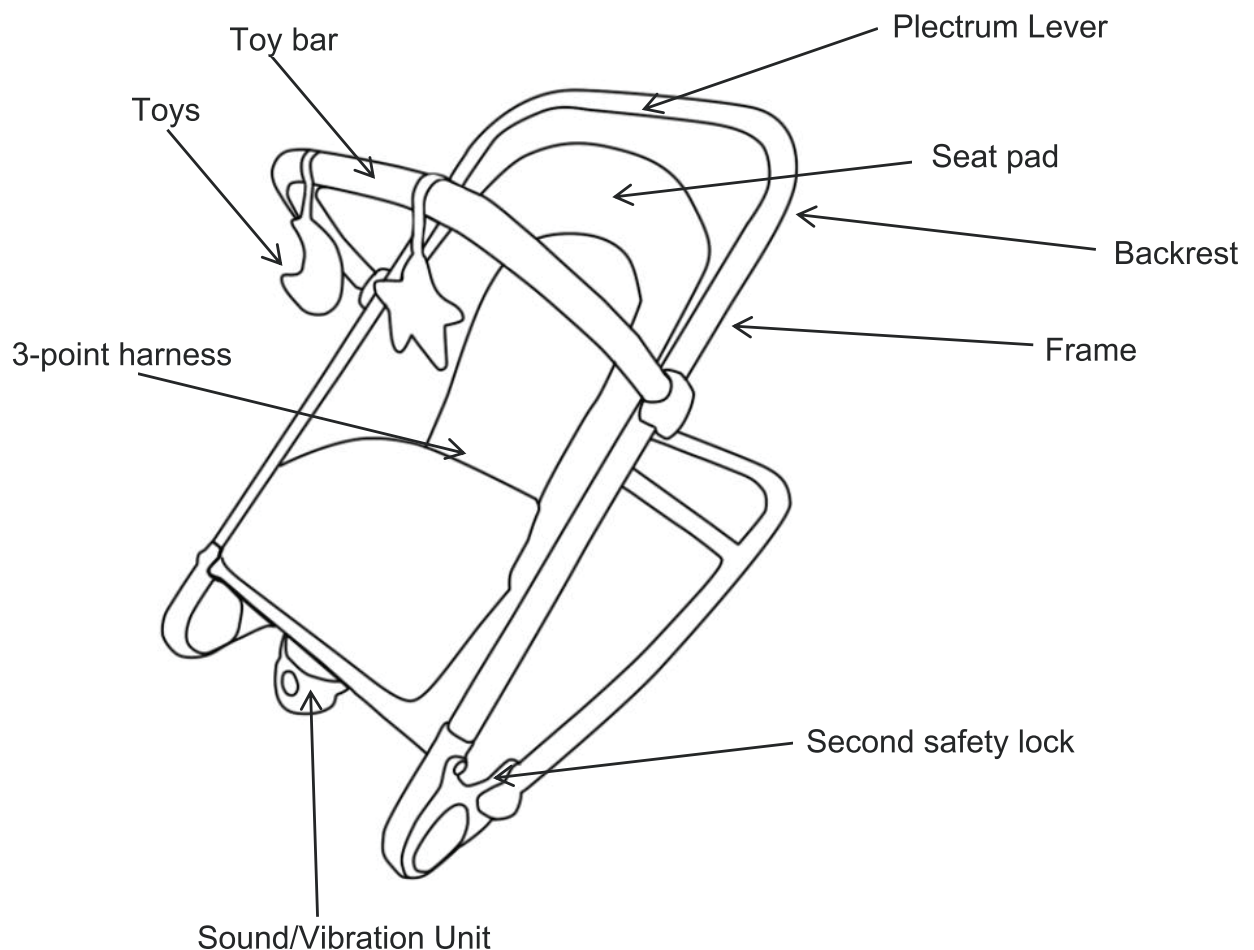



# WARNING

**IMPORTANT: READ THE INSTRUCTIONS CAREFULLY BEFORE USE AND KEEP THEM FOR FUTURE REFERENCE.**

- The product must be assembled by an adult.
- Never leave your child unattended.
- Do not use the product if some of its parts are broken, torn or missing.
- Do not use accessories or spare parts that are not approved by Dream On Me.
- Always use the restraint system! Always make sure that the safety harness and the crotch strap are fastened properly when the child is placed in the seat.
- Do not use this product when your child is able to sit up on his own or weights over 20 lbs.
- Do not use this product on raised surfaces such as tables, chairs etc.
- To prevent the risk of fire, never place the product near electrical appliances, gas cookers or other sources of intense heat.
- This product is not intended for any periods of sleeping.
- This product is not a replacement for a crib or bassinet. If the child needs to sleep, he should be moved to a crib or bassinet.
- Make sure that the fabric is always fitted correctly on the seat and backrest frame.
- Always keep children at a safe distance when opening and closing the baby rocker to prevent injury risks.
- Never allow children to play with the product.
- Never move the baby rocker when the child is sitting inside of it.
- Do not lift this product holding onto the toys bar.
- Always use under the supervision of an adult.
- Do not use the baby rocker for more than one child at a time.
- Never use the baby rocker on soft surfaces such as beds, sofas, cushions, as the baby rocker could fall over and cause suffocation.
- Never leave the baby rocker on surfaces which are not perfectly leveled.
- Do not allow other children to play unsupervised near the baby rocker.
- Never use this baby rocker to carry a child in motorized vehicles.
- Always check that all the components are fitted and assembled correctly.
- Make sure the product is assembled properly before using it.
- Periodically check for worn parts, loose screws, worn or frayed fabrics and immediately replace any damaged parts.
- Do not place the baby rocker near windows or walls, where strings, curtains or other objects may be used by the child to climb out of the baby rocker seat, and to prevent the risk of suffocation or choking.
- Do not place the baby rocker near windows or walls, to prevent the child from affecting the stability of the baby rocker, making it topple over, by pushing with his feet against the wall.
- Always check that there are no objects that can interfere with or block the movement of the baby rocker.
- Always make sure that before use of the baby rocker, that the adjustment lever is securely locked.
- Never pick the baby rocker up with the baby in it.
- Do not hang any toy or product on the toy bar or the rocker which has not been supplied with the rocker by Dream On Me.
- Do not make changes that might affect the safety of the child.
- Remove the packaging and dispose of it safely. Bags can be dangerous when handled by children.
- Never pick the cradle up with the baby in it.
- Do not hang any toy or product on the toy bar or the hammock which has not been supplied with the rocker by the manufacturer.
- Do not make changes that might affect the safety of the child.
- Remove the packaging and dispose of it safely. Bags can be dangerous when handled by children.
- Do not use the toy bar as a handle to lift the rocker.

# How to Use

Place the baby on the seat as shown in figure below.



Position the crotch straps between the baby's legs and insert the fastening tabs into the side, right and left buckles. Make sure at this time that the baby's hands are not close to the buckles. A click will indicate that they have been correctly attached.

To adjust the safety belt to your child's size, pull the loose end of the strap.

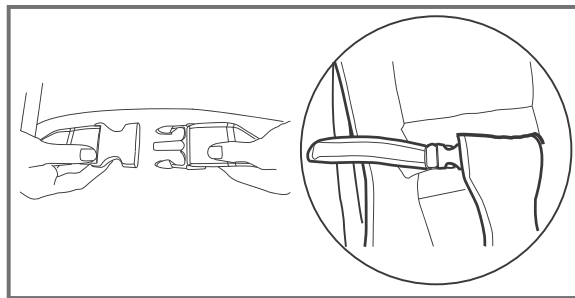

**Caution:** Do not adjust the belt too tightly; correct adjustment should allow you to insert one finger between the strap and your child.

# Features

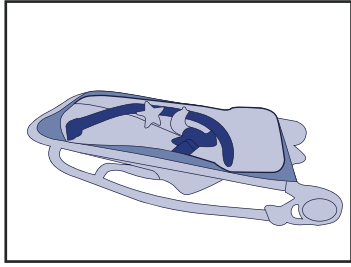

1. Take out the rocker from the box.

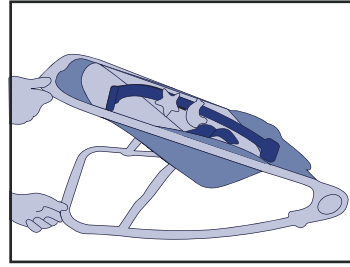

2. The seat has two positions, use your hands open the seat to position one. NEVER adjust angle of the seat while your baby is in the rocker.

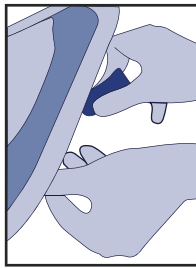

3. Rotate the lever clockwise to unfold and move the seat up.

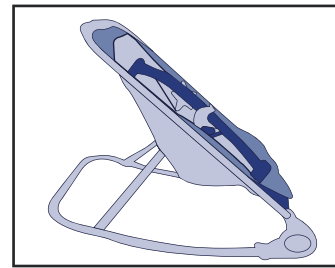

4. The seat can be moved up further with another rotation of the lever.

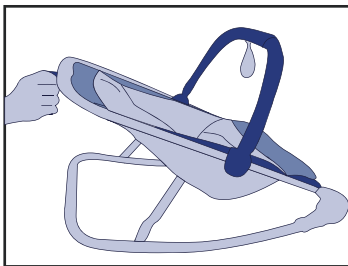

5. Attach the toy-bar to the frame using the pressing clips onto frame. The toy-bar can be adjusted forward or backward.

## Music/Vibration Unit

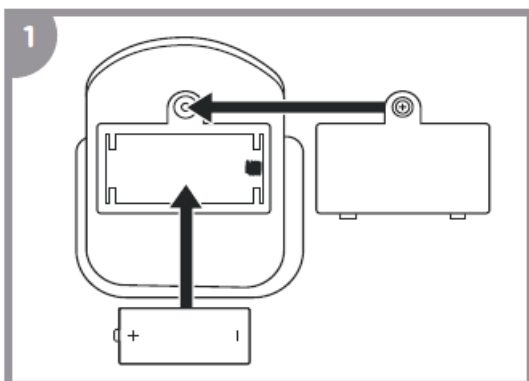

Unscrew the battery panel on the back of the Music/Vibration Unit, insert 1 C battery, and close the battery panel and secure with the screw.

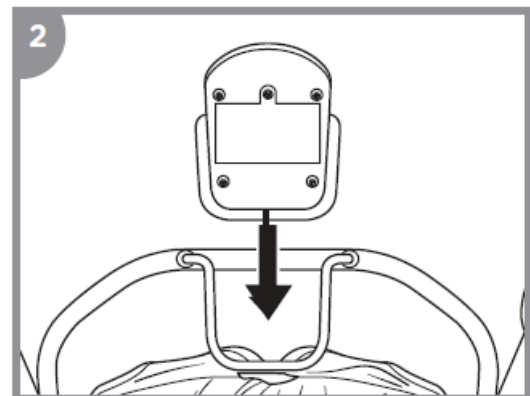

Slide the Music/Vibration Unit into the frame until it clicks into place.

# Features

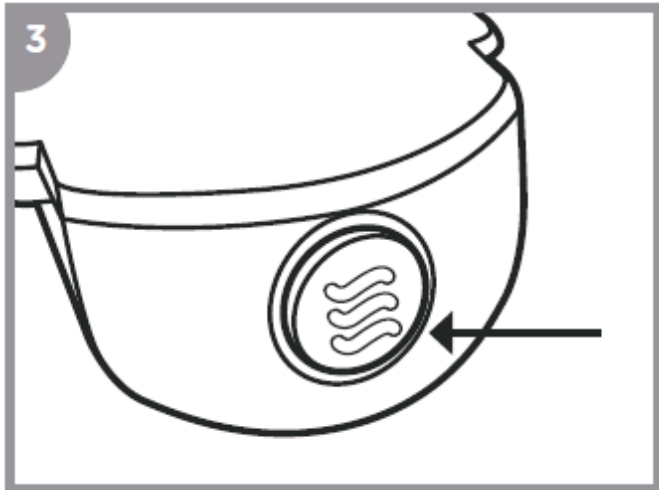

Press the button shown to turn the vibration and music on and off. After 15 minutes, the Music/Vibration Unit will shut off on its own.

## Using the 3-Point Harness

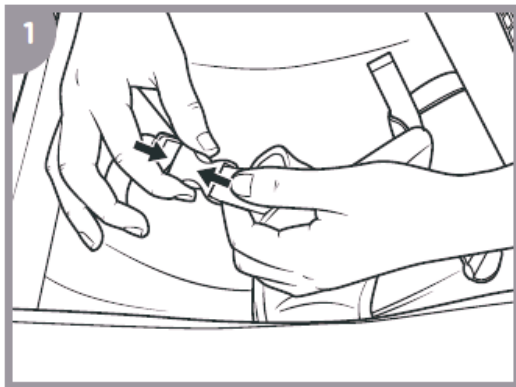

Unbuckle the restraint straps and buckle the child into the seat.

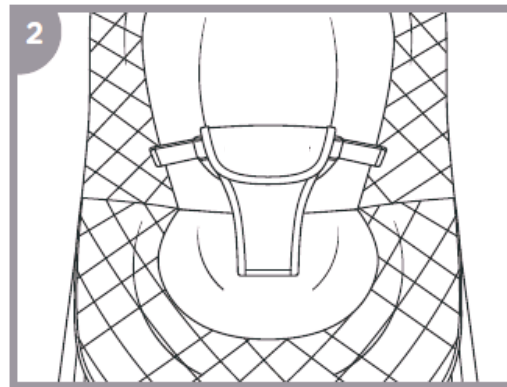

Buckle the child into the restraint straps and tighten them for a snug and secure fit.

## Folding the Rocker



1. Rotate the lever clockwise.

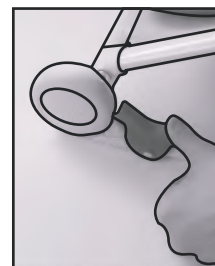

2. Press the secondary safety levers on both sides to move the seat downward to first recline position and then to the folded position.

# Maintenance

- The product has a resistant fabric cover which is completely removable and washable.
- The removal/application activities should be carried out by adults only. On a regular basis, check the condition of the product for any possible damage. In the case of damage, do not use it and keep it out of the reach of children.
- For washing of the fabric, carefully comply with instructions indicated on the label.
- For cleaning, do not use solvents, abrasive or aggressive products.

## Care and Cleaning

- Seat pad: Remove from frame. Fasten Buckles on seat restraint and seat pad, Machine wash with cold water, gentle cycle. No bleach, Tumble dry, Low heat.
- Toy bar and toys: Wipe clean with a damp cloth and mild soap.
- Air dry: Don't immerse in water
- Frame: Wipe the metal frame with soft, clean cloth and mild soap.



Hand wash in cold water



Do not bleach



Do not tumble dry



Do not iron



Do not dry clean



Dream On Me Inc.  
1532 S Washington Ave,  
Piscataway Twp. NJ 08854



1532, S. Washington Avenue  
Piscataway, NJ 08854  
E-mail: [info@dreamonme.com](mailto:info@dreamonme.com)

[www.dreamonme.com](http://www.dreamonme.com)

Follow us on



**@dreamonmeinc**



**@dreamonmeinc**

to get your nursery featured on our social media.

**Enter our monthly giveaway!**

Simply scan the QRcode to register.



**Chat with us!**

For any questions or concerns or feedback.



**DOM**  
FAMILY



**slumber baby**

  
**sweetpea baby**

**évolur**  
evolving with your baby